

© Andy Thornton Contracts Ltd.  
 No part of this drawing may be reproduced without prior written permission. Andy Thornton Contracts Ltd reserves all copyrights on its designs.  
 Many of the designs are also the subject of registered design right.

DO NOT SCALE IF IN DOUBT ASK

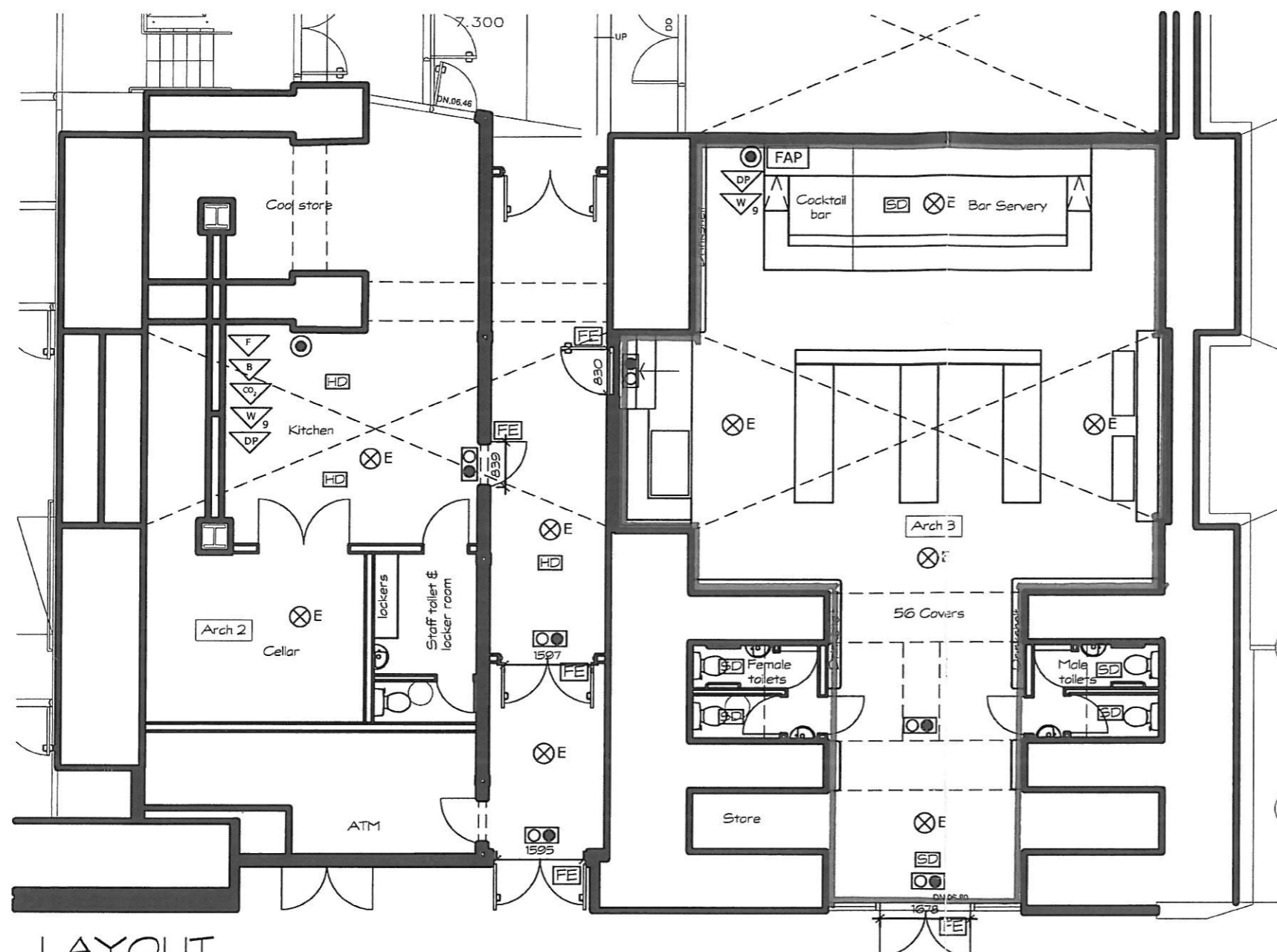

LAYOUT  
 Scale 1:100

**FIRE PREVENTION KEY**

THE LOCATION AND TYPE OF ANY FIRE SAFETY AND OTHER FIRE SAFETY EQUIPMENT IS SHOWN AS IT IS AT PRESENT. THIS MAY BE VARIED FROM TIME TO TIME WITH THE AGREEMENT OF THE FIRE OFFICER OR AFTER FIRE RISK ASSESSMENT.

- FAP** Fire Alarm Panel
- EXIT** Illuminated EXIT sign.
- E** Areas to be covered by emergency lighting. (Layout to be provided by electrician for approval)  
 Emergency lighting to be installed in accordance with BS 5266 Part 1:1988 & to achieve min. lighting level of 0.2 Lux on all Escape Routes.
- Break Glass Fire Alarm Call Point.

- SD** Automatic Smoke Detector with integral base sounder
- HD** Rate of Rise Heat Detector with integral base sounder
- F** AFFF Extinguisher - 6 litre capacity.
- CO<sub>2</sub>** Co2 Extinguisher - 2 kg capacity.
- DP** Dry Powder Extinguisher - 2.25 kg or 4.5 kg capacity.
- W<sub>9</sub>** Water Extinguisher - 9 litre capacity.
- B** Fire Blanket - 1.2m x 1.2m.
- All fire fighting equipment to be in accordance with BS 5306.
- RED LINE INDICATES EXTENT OF WHERE ALCOHOL IS SOLD

REV DATE DETAILS INITIAL

PROJECT PELT TRADER  
 CANNON STREET  
 LONDON  
 CLIENT BLOOMSBURY LEISURE  
 JON DALTON

TITLE LICENSING DRAWING

DRG No. 14727-001 SCALE 1:100 @ A3

DRN BY K.P.RCHK BY DATE 17/12/12

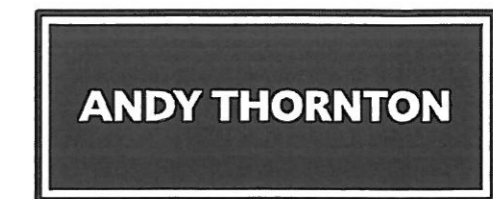

ANDY THORNTON CONTRACTS LIMITED  
 Ainleys Industrial Estate, Elland, West Yorkshire, HX5 9JP, England  
 Tel: +44 (0)1422 700 007 Fax: +44 (0)1422 700 008  
 Email: contracts@andythorntoncontracts.com  
 www.andythornton.com