



**NOTES:**  
 1) This plan is for illustrative purposes only.  
 2) This plan shows the general position, not the exact line, of the boundaries.  
 3) Measurements scaled from this plan may not match measurements between the same points on the ground.

**Key**

 Area to be Stopped-Up

 Site Boundary

1. Clerk's Place - Area = 265m<sup>2</sup>  
 2. Wrestlers Court - Area = 137m<sup>2</sup>  
 3. South of Camomile Street - Area = 56m<sup>2</sup>

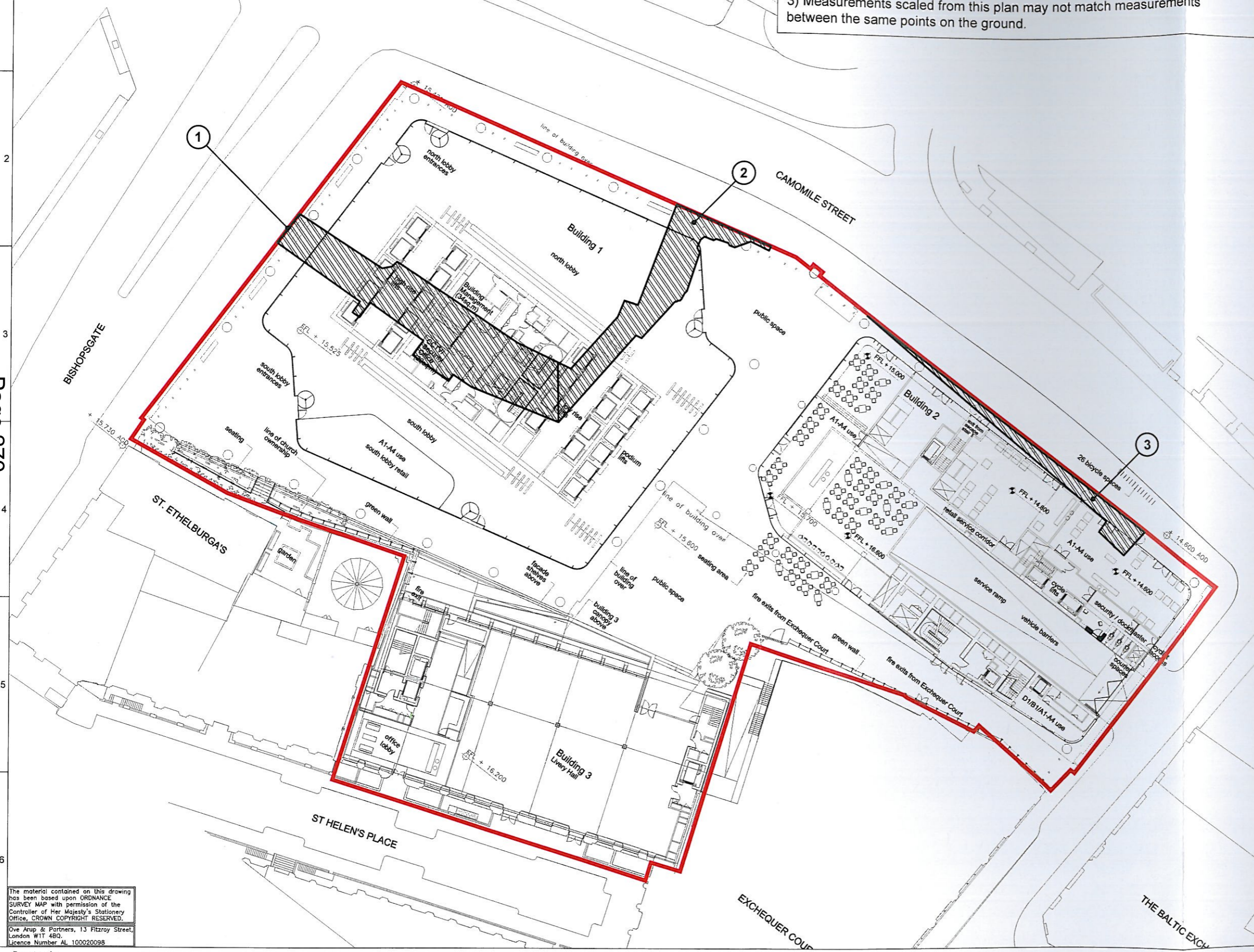

Issue	Date	By	Chkd	Appd
F	11/01/12	MW	PdeJ	PdeJ
E	12/11/10	MW	PdeJ	PdeJ
D	26/10/10	GW	PdeJ	PdeJ
C	20/10/10	GW	PdeJ	PdeJ
B	07/10/10	GW	PdeJ	PdeJ
A	05/10/10	MW	PdeJ	PdeJ
-	24/08/10	GW	PdeJ	PdeJ

# ARUP

13 Fitzroy Street  
 London W1T 4BQ  
 Tel +44 (0)20 7636 1531 Fax +44 (0)20 7580 3924  
 www.arup.com

Client  
**Brookfield Europe LP**

Job Title  
**100 Bishopsgate**

Drawing Title  
**Stopping-Up of Highways  
 (City of London) (No. \_\_) Order 200  
 City of London Plan No. PC \_\_  
 Proposed Order Plan**

Scale at A3  
 1:500

Discipline  
**Civil - Transport**

Drawing Status  
**DRAFT**

Job No <b>213737-00</b>	Drawing No <b>213737-SUO-102</b>	Issue <b>F</b>
----------------------------	-------------------------------------	-------------------

The material contained on this drawing has been based upon ORDNANCE SURVEY MAP with permission of the Controller of Her Majesty's Stationery Office, CROWN COPYRIGHT RESERVED.  
 © Arup & Partners, 13 Fitzroy Street, London W1T 4BQ.  
 Licence Number AL 100020098

I:\global\london\AFE\Jobs\213000-213737-00\_100\_Bishopsgate\3\_4\_Transportation Internal project data\ Internal Project Data\4-03\_Arup Drawings\Stopping Up base plans & info\213737-SUO-102\_F.dwg 12 Jan 2012 13:49:49 id: 0EAE0641-5ED1-48EF-A88C-BB90203FF581 manual.williams

This page is intentionally left blank