

NOTES

1. New catch pits to be connected to nearest adjacent road gully covered by the footway build-out.
2. Crossfalls on the footway build-outs to fall towards the carriageway wherever possible.
3. All existing covers to be raised to new footway levels.
4. All existing yellow lines, parking & loading bays to be relocated outwards to the new kerblines.

KEY

- Vehicle Lane Widths minimum 3.5m
- 200mm solid white line separating vehicles, cyclists and pedestrians
 - Vehicle movement
 - Direction of travel (cycles)
 - Signpost

- FG-Kerb separation and protection from TMP
- FG-Kerb Bollards from TMP
- Proposed c/w surfacing
- Proposed kerb build-outs to replace existing temporary lines and separator roads

- Proposed planters

Pedestrian Priority Programme

King Street

DEPARTMENT OF THE
BUILT ENVIRONMENT
City of London
Corporation
PO Box 270
Guildhall
London EC2P 2EJ
020 7332 1710



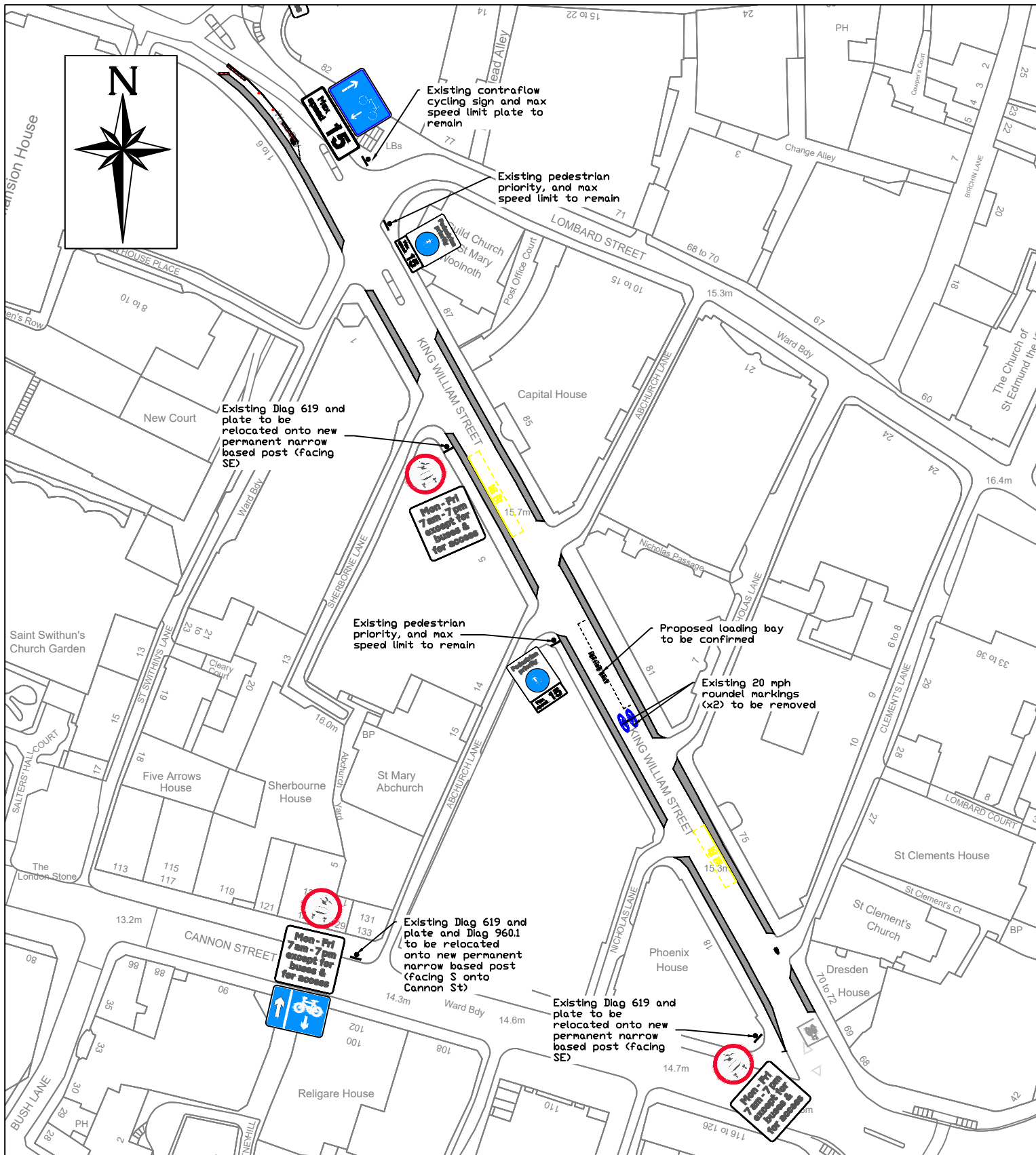

NOTES

1. New catch pits to be connected to nearest adjacent road gully covered by the footway build-out.
2. Crossfalls on the footway build-outs to fall towards the carriageway wherever possible.
3. All existing covers to be raised to new footway levels.
4. All existing yellow lines, parking & loading bays to be relocated outwards to the new kereline.
5. All street furniture & signage to have a minimum of 450mm set back from front of kerb

KEY

- Vehicle Lane Widths minimum 3.5m
- 200mm solid white line separating vehicles, cyclists and pedestrians
 - Vehicle movement
 - Direction of travel (cycles)
 - Signpost

- FG-Kerb separation and protection from TMP
- FG-Kerb Bollards from TMP
- Proposed planters
- Proposed kerb build-outs to replace existing temporary lines and separator wands

Pedestrian Priority Programme

King William Street

DEPARTMENT OF THE
BUILT ENVIRONMENT
City of London
Corporation
PO Box 270
Guildhall
London EC2P 2EJ
020 7332 1710



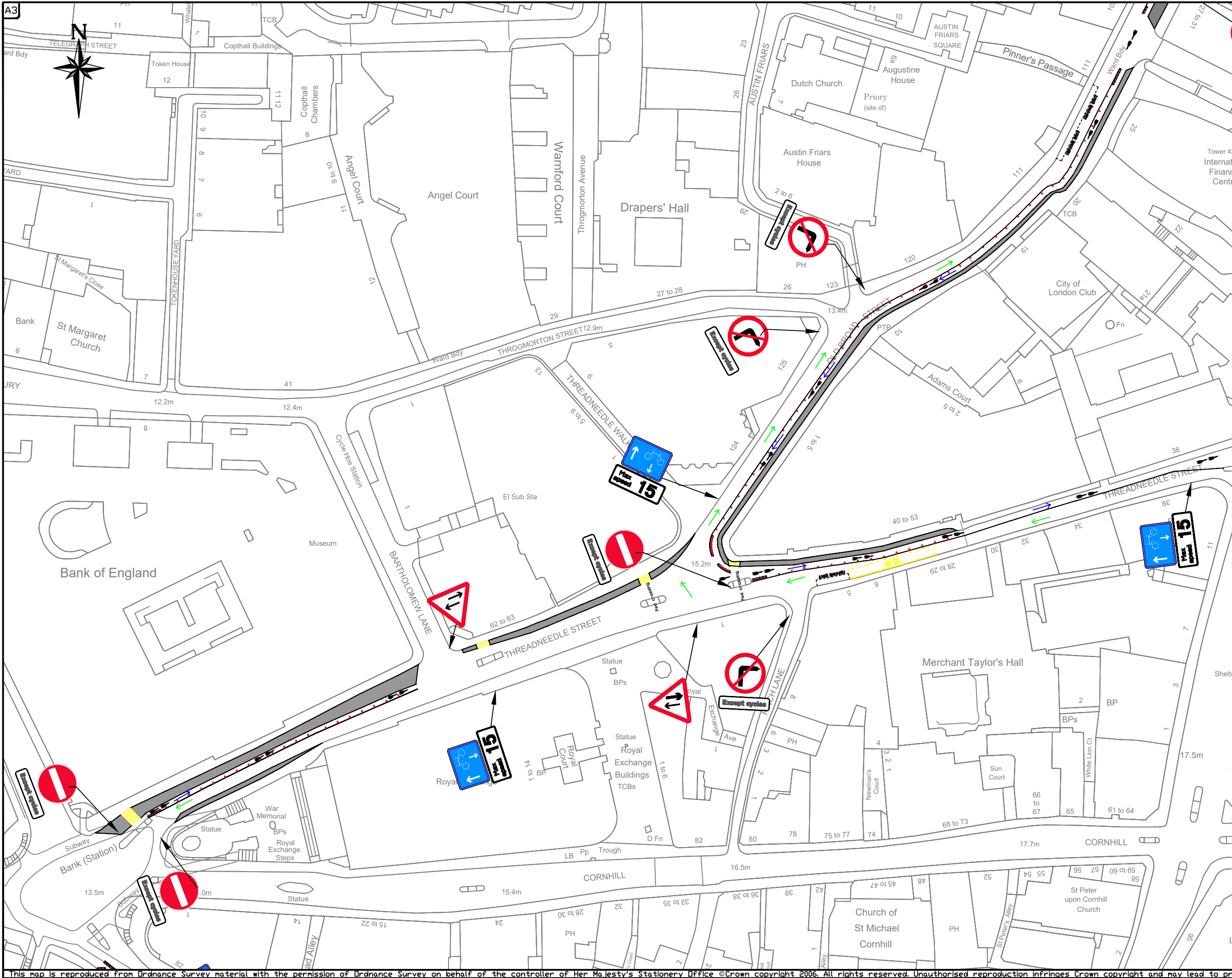

KEY

Vehicle Lane Widths minimum 3.5m

200mm solid white line separating vehicles, cyclists and pedestrians

Vehicle movement

Direction of travel (cycles)

Signpost

FG-Kerb separation and protection from TMP

FG-Kerb Bollards from TMP

Proposed c/w surfacing

Footway dropped to pedestrian point

- NOTES**
1. New catch pits to be connected to nearest adjacent road gully covered by the footway build-out.
 2. Crossfalls on the footway build-outs to fall towards the carriageway wherever possible.
 3. All existing covers to be raised to new footway levels.
 4. All existing yellow lines, parking & loading bays to be relocated outwards to the new kerbline.
 5. All street furniture and signage to have minimum 450mm set-back from front of kerb.

Rev	Date	Revision detail	Drawn	Checked	Approved

Project
Pedestrian Priority Programme

Drawing title
**Threadneedle St
Sheet 1 of 2**

Scale	Original dwg-size	Date
NTS	A3	30/09/21
Drawn	MYC	Checked CB
		Approved XXX

DEPARTMENT OF PLANNING & TRANSPORTATION
City of London Corporation
PO Box 270
Guildhall
London EC2P 2EJ
020 7332 1710

CITY OF LONDON

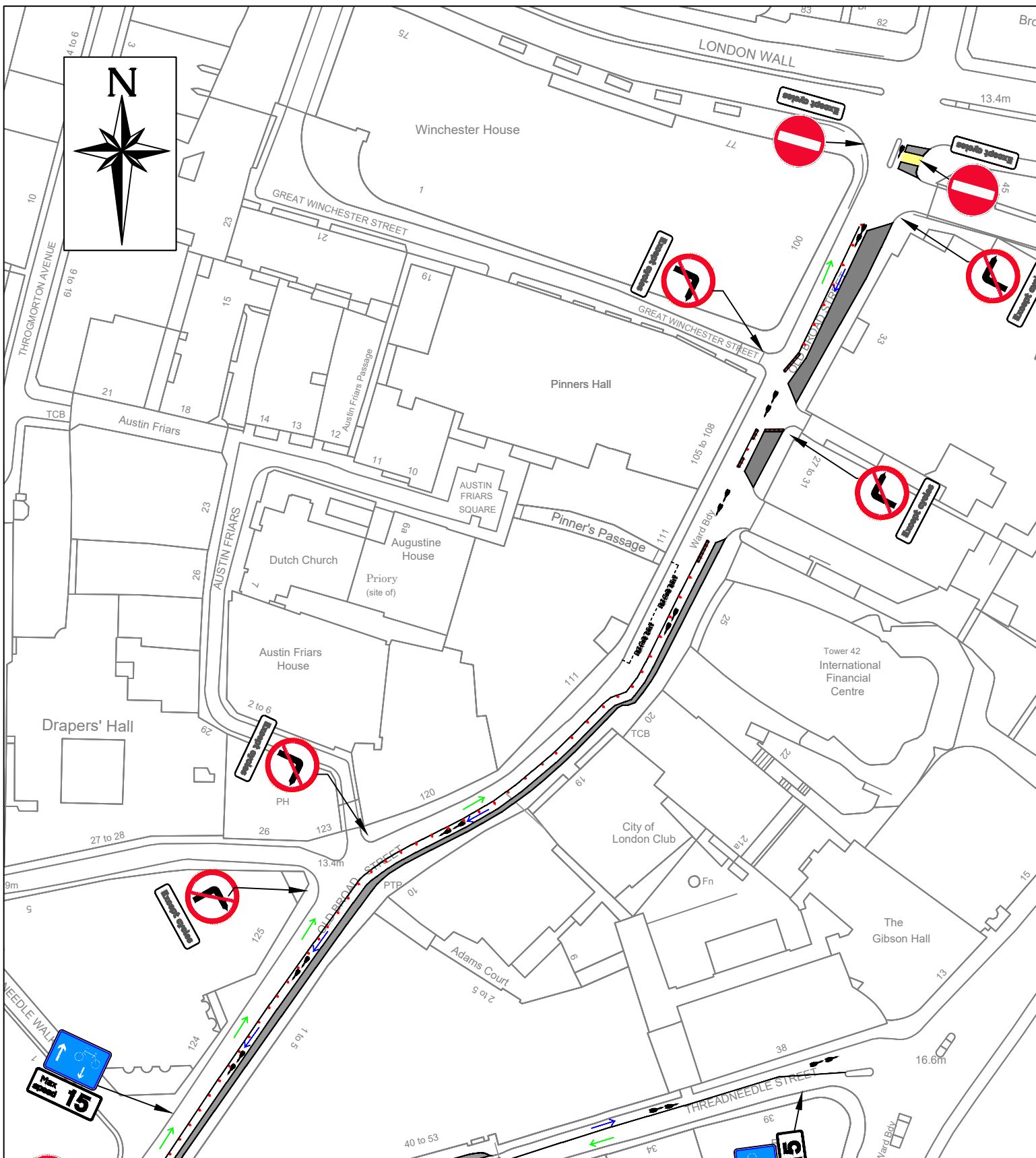

NOTES

1. New catch pits to be connected to nearest adjacent road gully covered by the footway build-out.
2. Crossfalls on the footway build-outs to fall towards the carriageway wherever possible.
3. All existing covers to be raised to new footway levels.
4. All existing yellow lines, parking & loading bays to be relocated outwards to the new kerblines.

KEY

Vehicle Lane Widths minimum 3.5m

- 200mm solid white line separating vehicles, cyclists and pedestrians
- Vehicle movement
- Direction of travel (cycles)
- Signpost

FG-Kerb separation and protection from TMP

FG-Kerb Bollards from TMP

Proposed c/w surfacing

Proposed kerb build-outs to replace existing temporary lines and separator wands

Footway dropped to pedestrian point

Pedestrian Priority Programme

Threadneedle Street (Sheet 2 of 2)

DEPARTMENT OF THE
BUILT ENVIRONMENT
City of London
Corporation
PO Box 270
Guildhall
London EC2P 2EJ
020 7332 1710



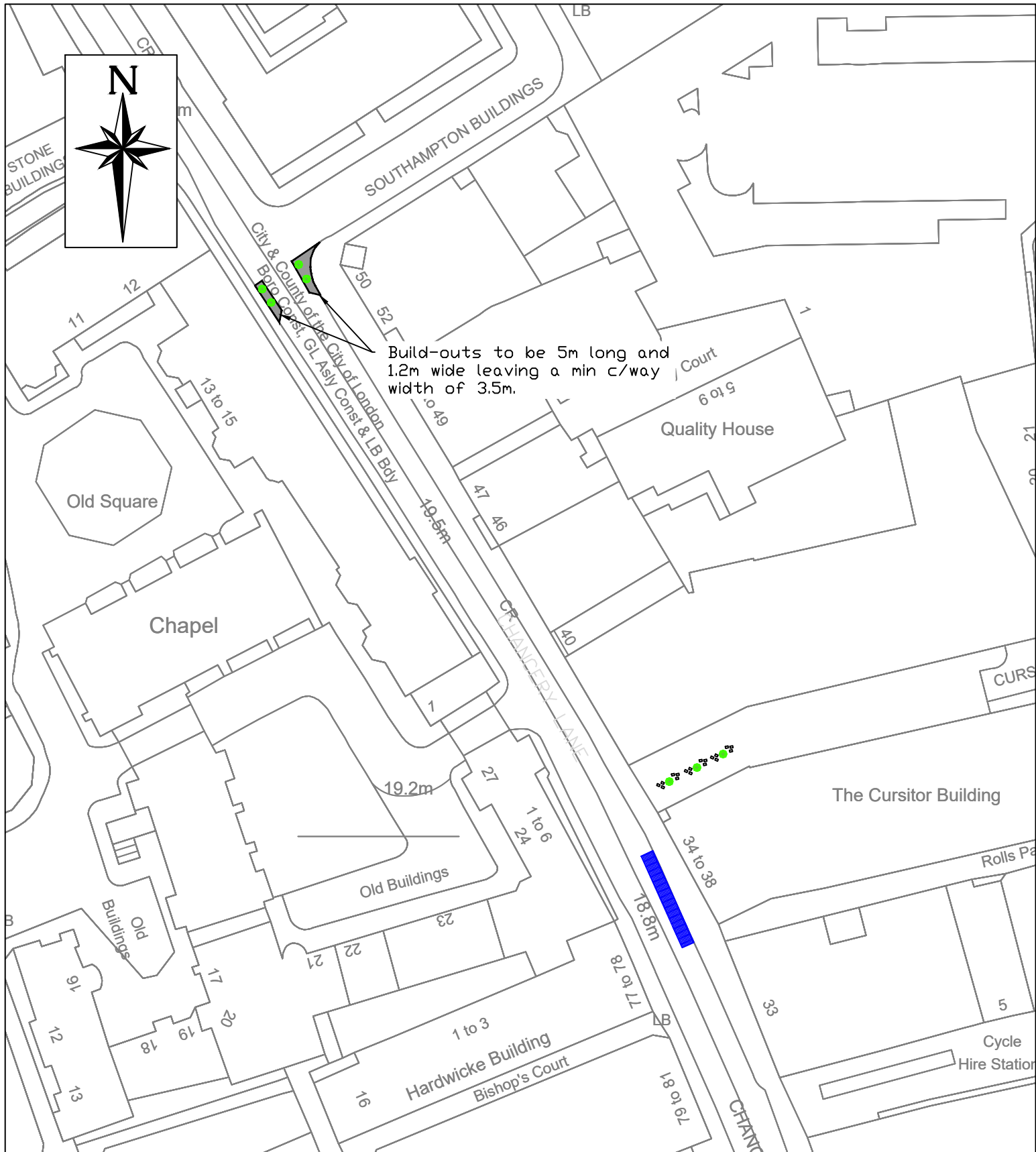

NOTES

1. New catch pits to be connected to nearest adjacent road gully covered by the Footway build-out.
2. Crossfalls on the Footway build-outs to fall towards the carriageway wherever possible.
3. All existing covers to be raised to new Footway levels.
4. All existing yellow lines, parking & loading bays to be relocated outwards to the new kerbline.
5. All street furniture & signage to have a minimum of 450mm set back from front of kerb

KEY

Vehicle Lane Widths minimum 3.5m

- 200mm solid white line separating vehicles, cyclists and pedestrians
- Vehicle movement
- Direction of travel (cycles)
- Signpost

- FG-Crub separation and protection from TMP
- FG-Crub Bollards from TMP
- Proposed planters
- Proposed parklet (x2)

- Proposed kerb build-outs to replace existing temporary lines and separator wands
- Proposed seating and planters

Pedestrian Priority Programme

Chancery Lane (Sheet 1)

DEPARTMENT OF THE
BUILT ENVIRONMENT
City of London
Corporation
PO Box 270
Guildhall
London EC2P 2EJ
020 7332 1710



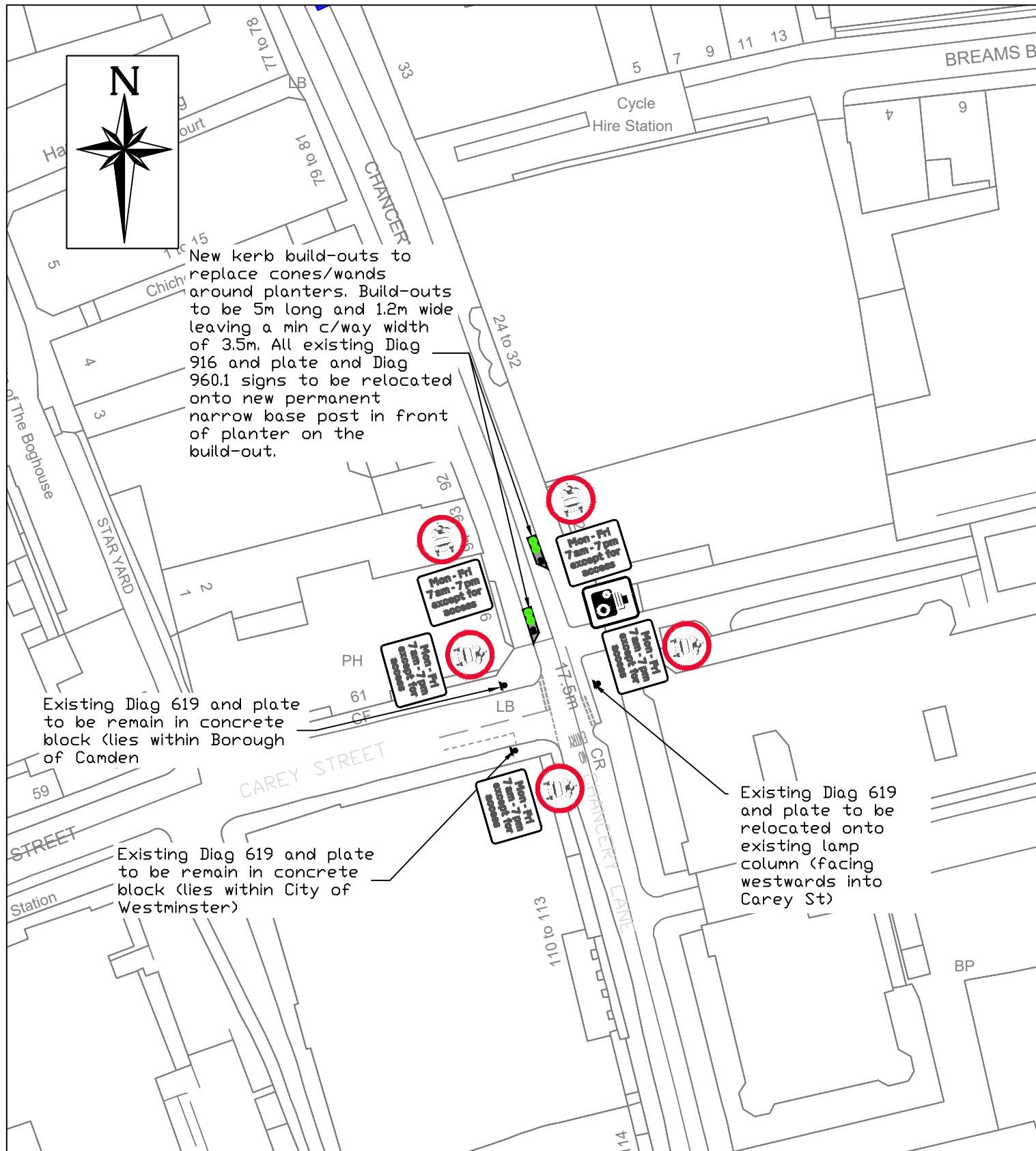

NOTES

1. New catch pits to be connected to nearest adjacent road gully covered by the footway build-out.
2. Crossfalls on the footway build-outs to fall towards the carriageway wherever possible.
3. All existing covers to be raised to new footway levels.
4. All existing yellow lines, parking & loading bays to be relocated outwards to the new kerbline.
5. All street furniture & signage to have a minimum of 450mm set back from front of kerb

KEY

- Vehicle Lane Widths minimum 3.5m
- 200mm solid white line separating vehicles, cyclists and pedestrians
 - Vehicle movement
 - Direction of travel (cycles)
 - Signpost

- FG-Kerb separation and protection from THP
- FG-Kerb Bollards from THP
- Proposed planters
- Proposed parklet (x2)

- Proposed kerb build-outs to replace existing temporary lines and separator wands

Pedestrian Priority Programme

Chancery Lane (Sheet 2)

DEPARTMENT OF THE
BUILT ENVIRONMENT
City of London
Corporation
PO Box 270
Guildhall
London EC2P 2EJ
020 7332 1710

