

21/12/2021 13:54:19

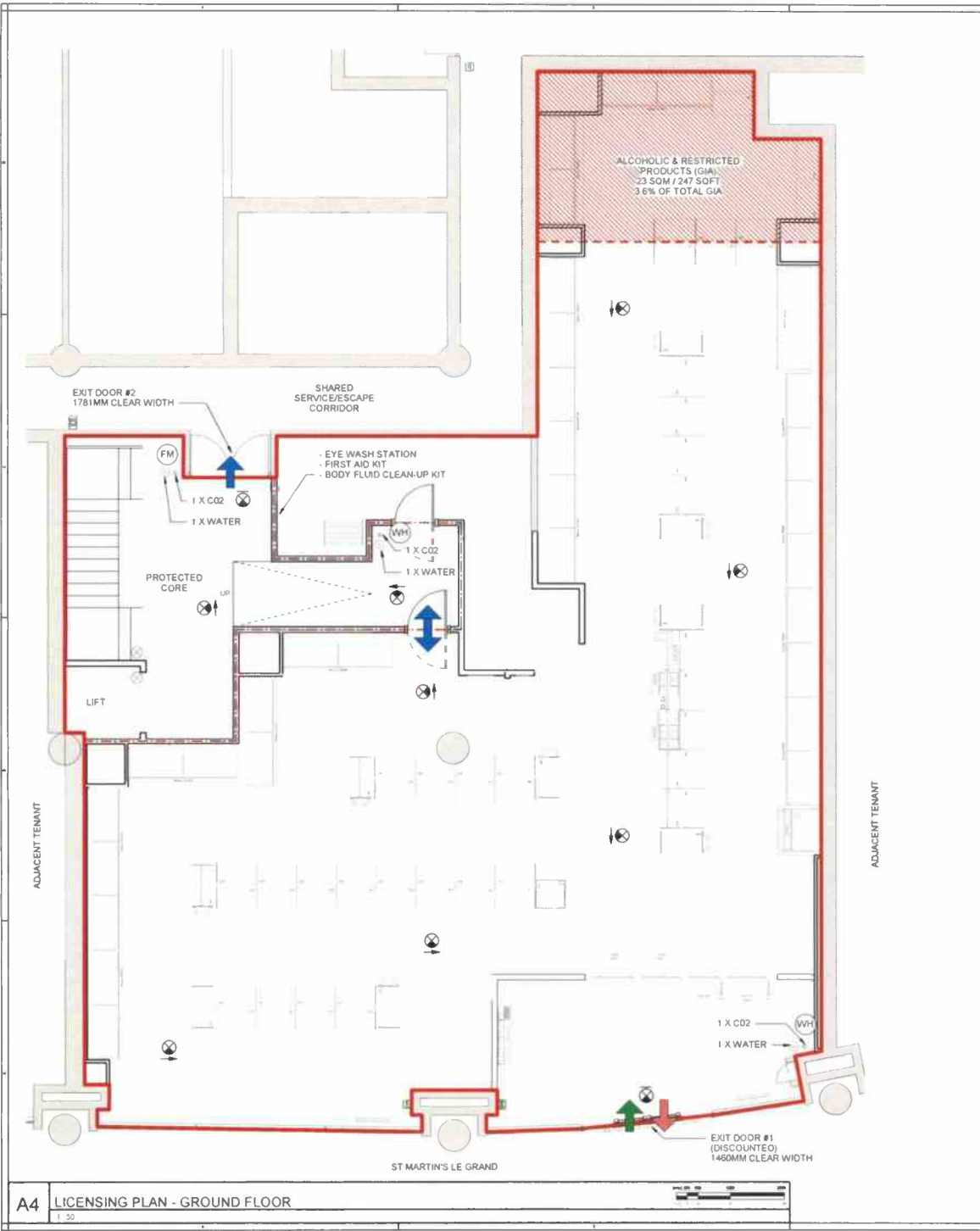

A4 LICENSING PLAN - GROUND FLOOR

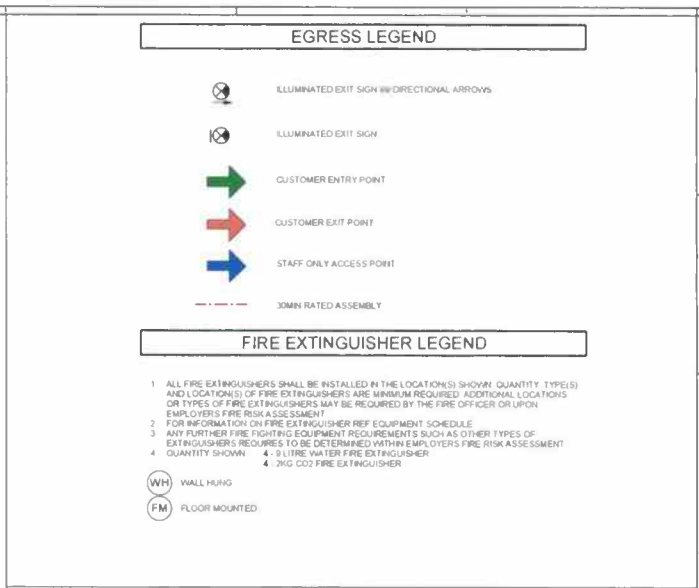

FIRE EXTINGUISHER LEGEND

1. ALL FIRE EXTINGUISHERS SHALL BE INSTALLED IN THE LOCATION(S) SHOWN. QUANTITY, TYPE(S) AND LOCATION(S) OF FIRE EXTINGUISHERS ARE MINIMUM REQUIRED. ADDITIONAL LOCATIONS OR TYPES OF FIRE EXTINGUISHERS MAY BE REQUIRED BY THE FIRE OFFICER OR UPON EMPLOYER'S FIRE RISK ASSESSMENT.
2. FOR INFORMATION ON FIRE EXTINGUISHER REF. EQUIPMENT SCHEDULE.
3. ANY FURTHER FIRE FIGHTING EQUIPMENT REQUIREMENTS SUCH AS OTHER TYPES OF EXTINGUISHERS, REQUIRES, TO BE DETERMINED WITHIN EMPLOYER'S FIRE RISK ASSESSMENT.
4. QUANTITY SHOWN: 4. 9 LITRE WATER FIRE EXTINGUISHER 4. 2KG CO2 FIRE EXTINGUISHER

- (WH) WALL HUNG
- (FM) FLOOR MOUNTED

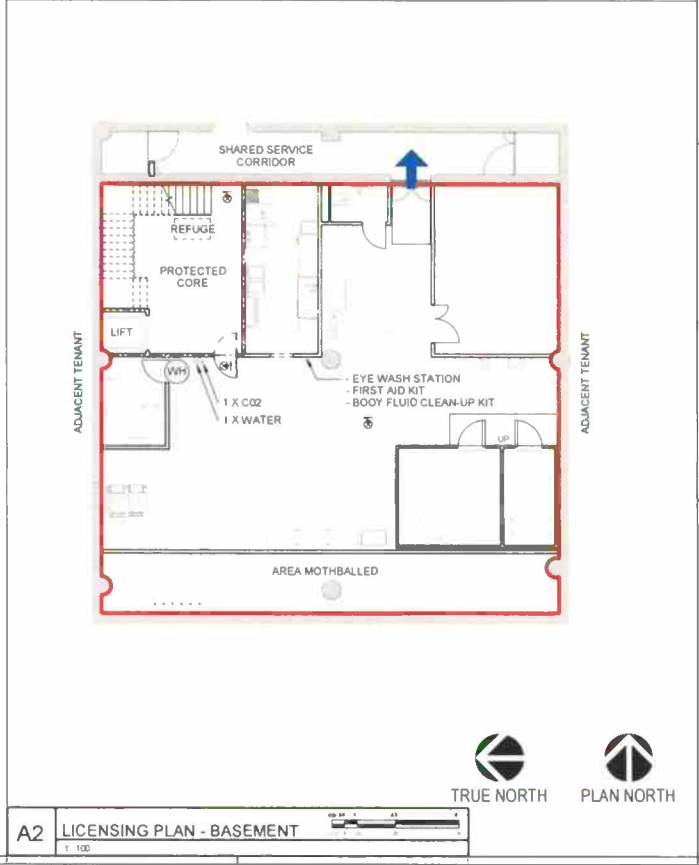

A2 LICENSING PLAN - BASEMENT

leonard
design architects

150 Cheapside, London, EC1A 4EN, UK

020 7460 1100

www.leonarddesign.com

Copyright Notice

This drawing is the property of Leonard Design Architects Ltd. It is to be used for the project only and is not to be reproduced, stored in a retrieval system, or transmitted in any form or by any means, electronic, mechanical, photocopying, recording, or by any information storage and retrieval system, without the prior written consent of Leonard Design Architects Ltd. All rights reserved.

Disclaimer

This drawing and proposed fit out is a guide only and does not constitute a contract. It is subject to the terms and conditions of the contract. The client is responsible for ensuring that the fit out complies with all applicable laws and regulations. Leonard Design Architects Ltd. is not liable for any errors or omissions in this drawing or for any consequences arising from its use. The client is advised to seek professional advice before proceeding with any fit out.

REV	DATE	DESCRIPTION

EN5482

EN5482
ADDRESS
150 CHEAPSIDE, LONDON,
CITY OF LONDON,
EC1A 4EN, UK

Project Name:
1254

Project No.:

Sheet No. - A1

Sheet Title:
LICENSING PLAN

Sheet No.:

RE-200