

IG's current proposal: this is a mock-up floorplan for the collaborative space on the 65a ground floor.

Advantages: Additional meeting spaces for IG, flexible space with movable wall (dotted line), 2 accessible desks on ground floor, touchdown bar area for flexible working

Disadvantages: doesn't look and feel collaborative/open

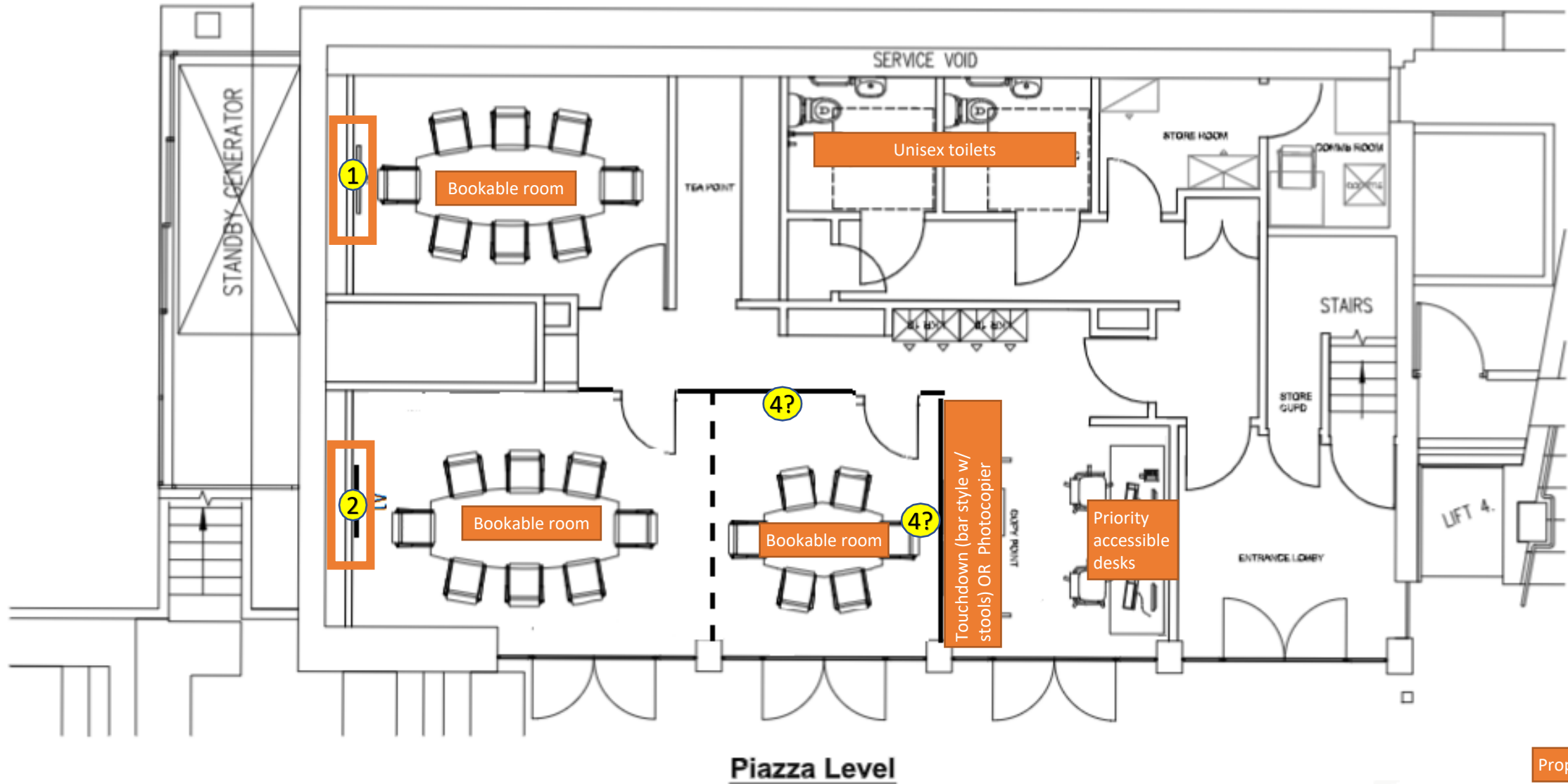

Proposed

IG's current proposal: this is a mock-up floorplan for the 65a first floor.

Advantages: With 2 meeting rooms downstairs, we propose to convert the upstairs meeting room into a flexible lunch/breakout space (keep the AV for meetings)

Disadvantages: none.

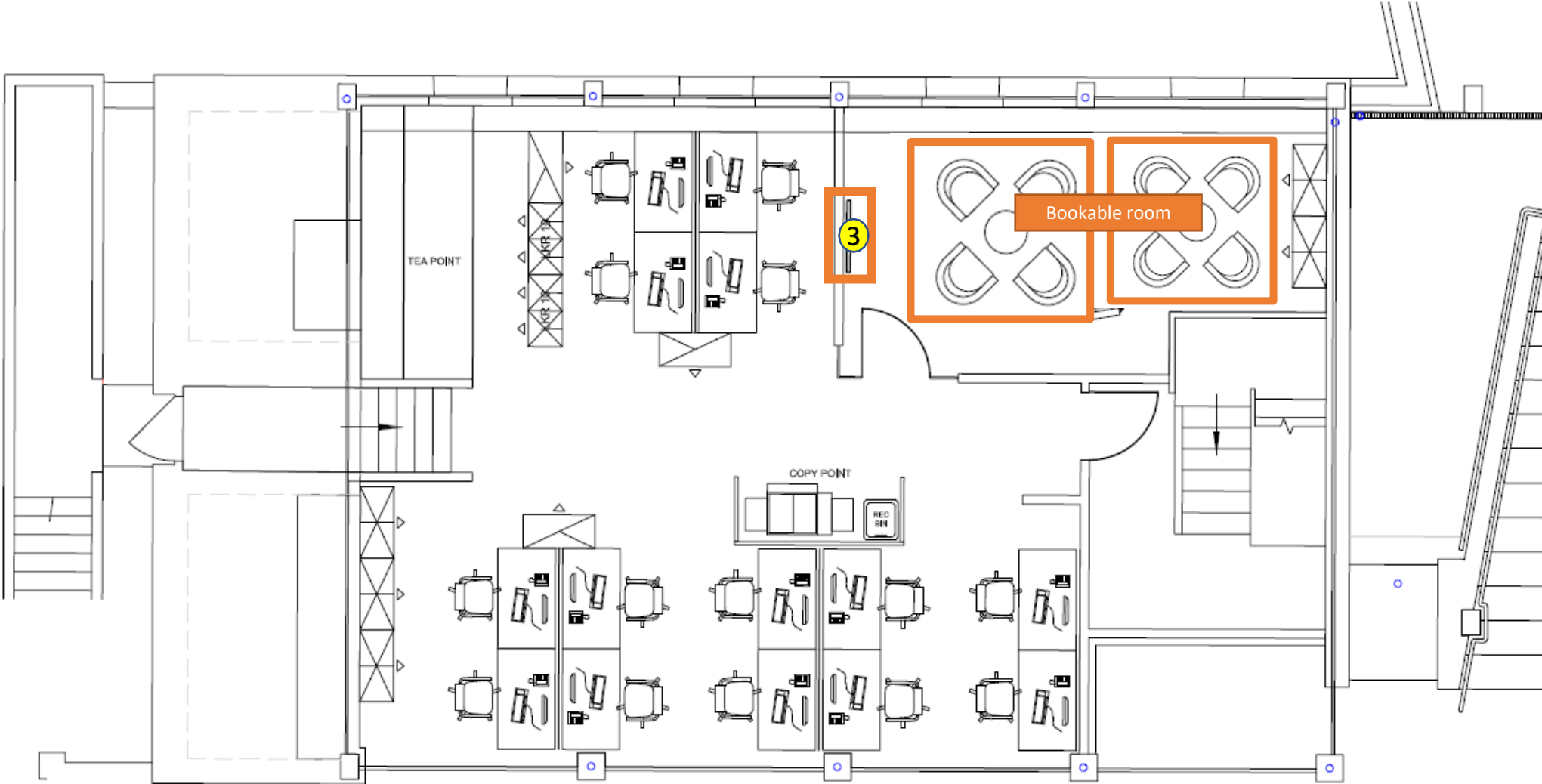

First Floor Level

Proposed