

DO NOT SCALE

- EXISTING TREES COVERED BY ARBORICULTURAL SURVEY  
Refer to drawing 5117039 COL LAG01-LAG16 for the Arboricultural survey
- EXISTING TREES NOT COVERED BY ARBORICULTURAL SURVEY  
Tree location taken from the Topographical survey
- POSITION OF TREES NOT SURVEYED  
Indicative location provided
- EXISTING LANDSCAPE
- EXISTING JAPANESE KNOTWEED  
Approximate location of Japanese knotweed plants to be managed
- EXISTING HIMALAYAN BALSAM  
Approximate location of Himalayan Balsam plants to be managed
- POND
- EXISTING POND VEGETATION
- EXISTING PATH
- CONTOURS
- EXISTING FENCE

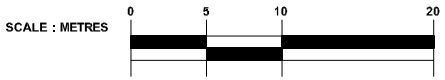

Drawing Status: **FOR INFORMATION** Substability: -

**ATKINS**

Woodcote Grove  
Ashley Road  
Epsom  
Surrey  
KT18 5BW

Tel: +44 (0)1372 726140  
Fax: +44 (0)1372 740055  
www.atkinsglobal.com

Copyright: © Atkins Limited (2014)

Client:

**City of London Corporation**

Project Title:

**HAMPSTEAD HEATH PONDS PROJECT**

Drawing Title:

**STOCK POND  
EXISTING SITE PLAN**

Scale	Designed	Drawn	Checked	Authorised
1:500	NM	IF	NM	LB
Original Size	Date	Date	Date	Date
A3	24/04/14	24/04/14	24/04/14	24/04/14
Drawing Number	Revision			
5117039-ATK-P1-ZZ-DR-L-7002	P1			

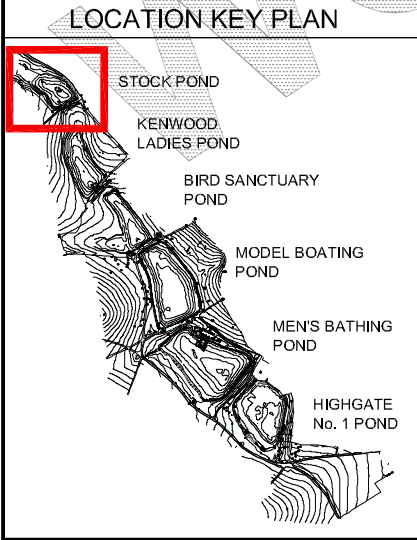



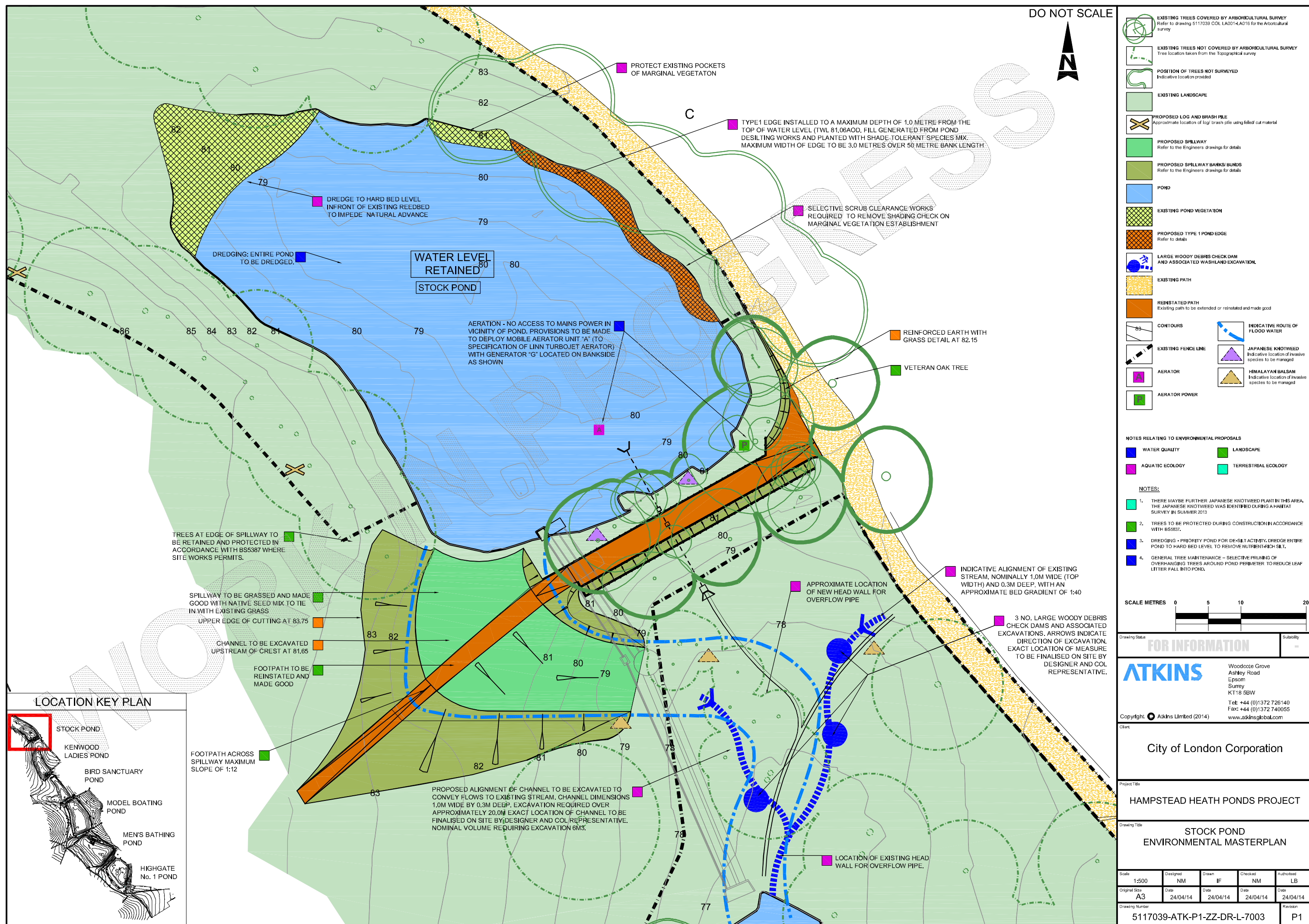



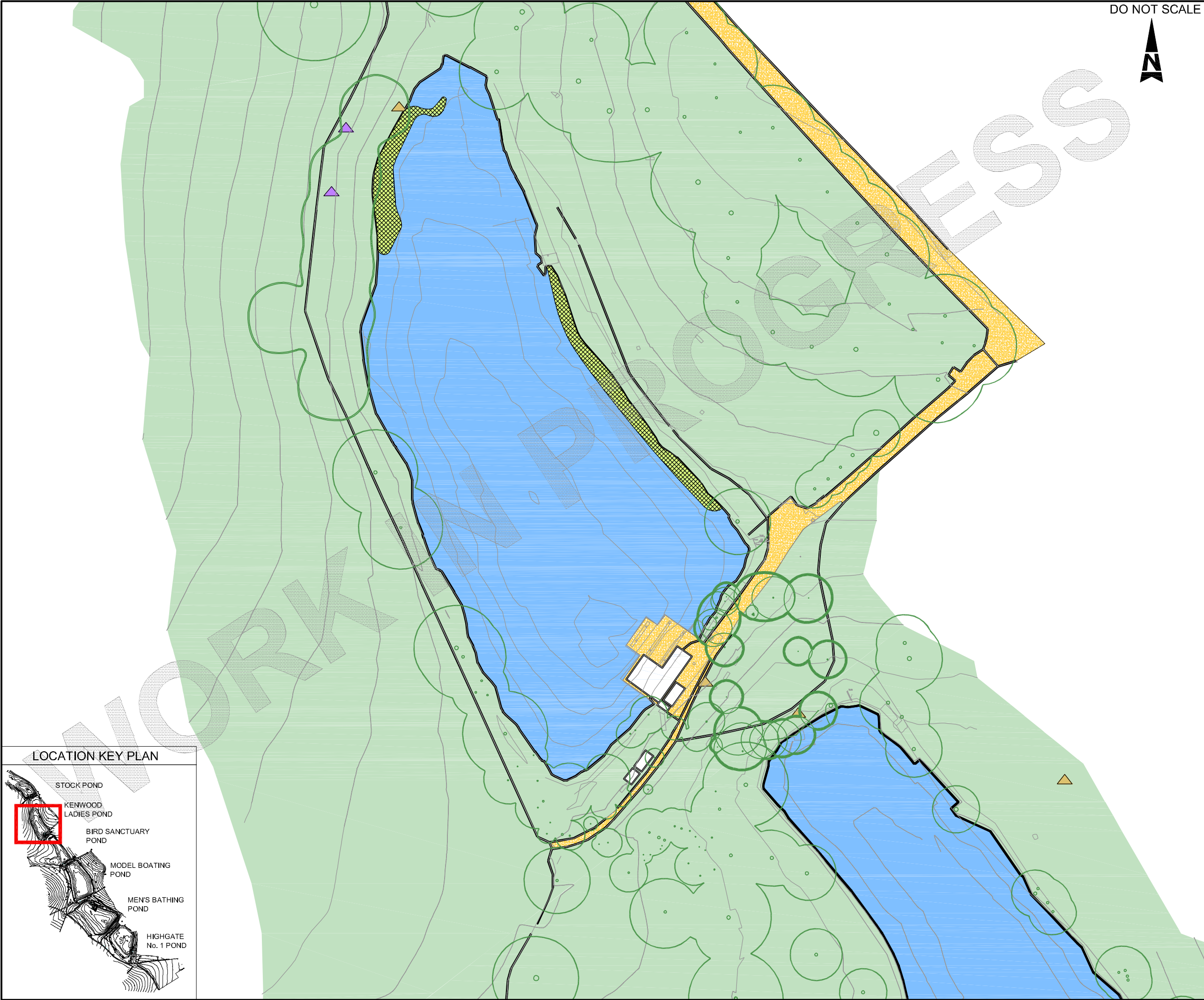

DO NOT SCALE

- EXISTING TREES COVERED BY ARBORICULTURAL SURVEY  
Refer to drawing 5117039 COL LA0214LA016 for the Arboricultural survey
- EXISTING TREES NOT COVERED BY ARBORICULTURAL SURVEY  
Tree location taken from the Topographical survey
- POSITION OF TREES NOT SURVEYED  
Indicative location provided
- EXISTING LANDSCAPE
- EXISTING JAPANESE KNOTWEED  
Approximate location of Japanese knotweed plants to be managed
- EXISTING HIMALAYAN BALSAM  
Approximate location of Himalayan Balsam plants to be managed
- POND
- EXISTING POND VEGETATION
- EXISTING PATH
- CONTOURS
- EXISTING FENCE



Drawing Status: **FOR INFORMATION**      Suitability: -

**ATKINS**      Woodcote Grove  
Ashley Road  
Epsom  
Surrey  
KT18 5BW  
Tel: +44 (0)1372 726140  
Fax: +44 (0)1372 740055  
www.atkinsglobal.com

Copyright: © Atkins Limited (2014)

Client:  
**City of London Corporation**

Project Title:  
**HAMPSTEAD HEATH PONDS PROJECT**

Drawing Title:  
**KENWOOD LADIE'S BATHING POND  
EXISTING SITE PLAN**

Scale	Designed	Drawn	Checked	Authorised
1:750	NM	IF	NM	LB
Original Size	Date	Date	Date	Date
A3	24/04/14	24/04/14	24/04/14	24/04/14
Drawing Number	Revision			
5117039-ATK-P2-ZZ-DR-L-7004	P1			

LOCATION KEY PLAN

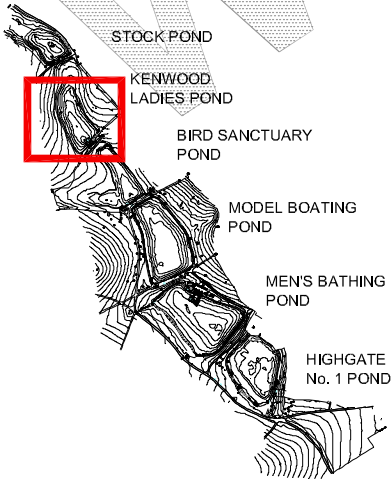



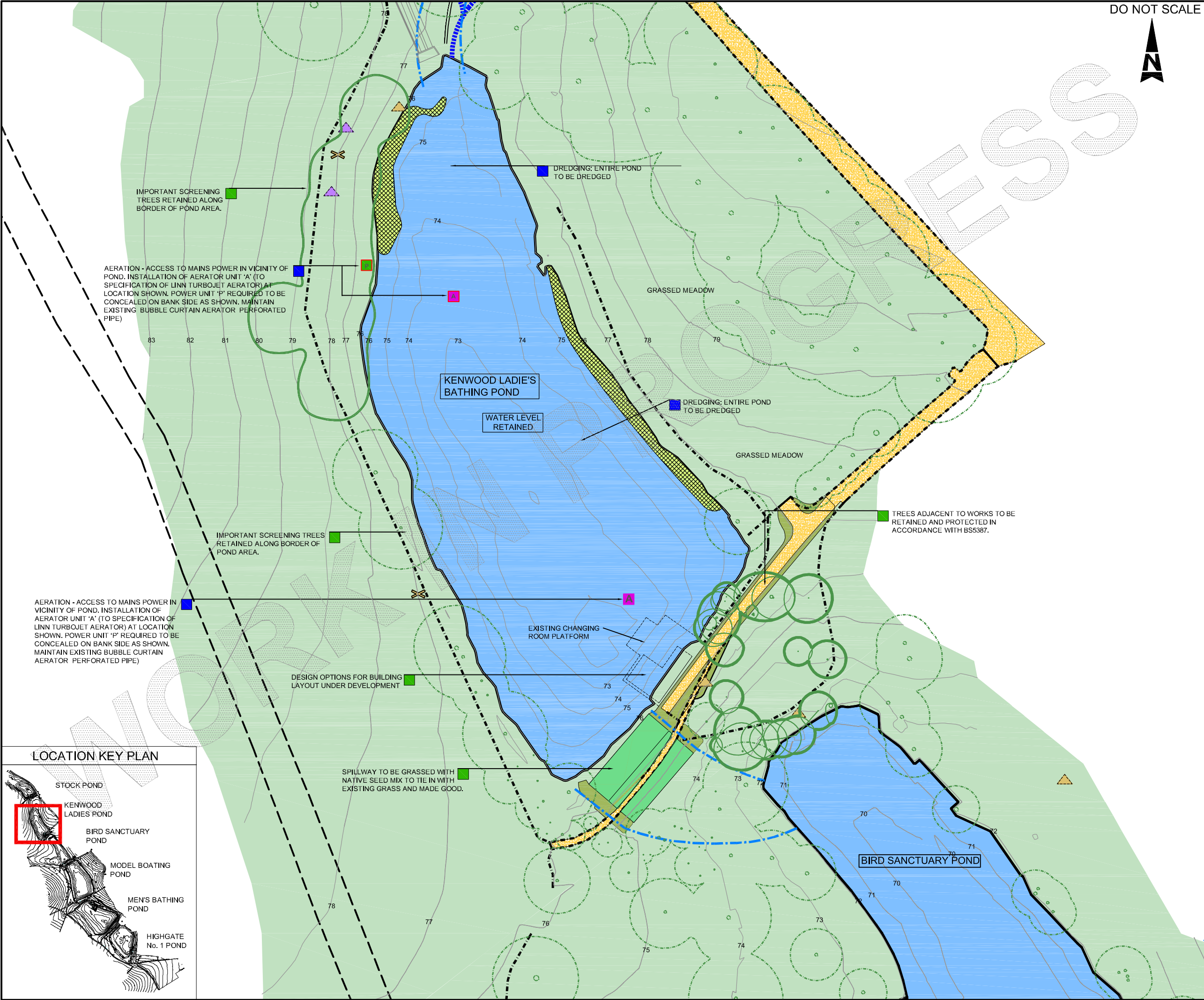

DO NOT SCALE

EXISTING TREES COVERED BY ARBORICULTURAL SURVEY  
Refer to drawing 5117039 COL LAD01-LAD16 for the Arboricultural survey

EXISTING TREES NOT COVERED BY ARBORICULTURAL SURVEY  
Tree location taken from the Topographical survey

POSITION OF TREES NOT SURVEYED  
Indicative location provided

EXISTING LANDSCAPE

PROPOSED LOG AND BRUSH PILE  
Approximate location of log/brush pile using felled cut material

PROPOSED SPILLWAY  
Refer to the Engineers drawings for details

PROPOSED SPILLWAY BANKS/BUNDS  
Refer to the Engineers drawings for details

POND

EXISTING POND VEGETATION

LARGE WOODY DEBRIS CHECK DAM AND ASSOCIATED WASHLAND EXCAVATION

EXISTING PATH

REINSTATED PATH  
Existing path to be extended or reinstated and made good

CONTOURS

EXISTING FENCE LINE

AERATOR

AERATOR POWER

INDICATIVE ROUTE OF FLOOD WATER

JAPANESE KNOTWEED  
Indicative location of invasive species to be managed

HIMALAYAN BALSAM  
Indicative location of invasive species to be managed

NOTES RELATING TO ENVIRONMENTAL PROPOSALS

WATER QUALITY

LANDSCAPE

AQUATIC ECOLOGY

TERRESTRIAL ECOLOGY

- NOTES:
1. THERE MAYBE FURTHER JAPANESE KNOTWEED PLANT IN THIS AREA. THE JAPANESE KNOTWEED WAS IDENTIFIED DURING A HABITAT SURVEY IN SUMMER 2013
  2. TREES TO BE PROTECTED DURING CONSTRUCTION IN ACCORDANCE WITH BS5837.
  3. BAT BOXES TO BE INSTALLED ON TREES - LOCATION AND EXTENT TBC DEPENDING ON TREE LOSS IN THIS AREA AND WHETHER ANY TREES WITH POTENTIAL FOR ROOSTING BATS WILL BE LOST
  4. DREDGING - PRIORITY POND FOR DE-SILT ACTIVITY, DREDGE ENTIRE POND TO HARD BED LEVEL TO REMOVE NUTRIENT-RICH SILT.
  5. GENERAL TREE MAINTENANCE - SELECTIVE PRUNING OF OVERHANGING TREES AROUND POND PERIMETER TO REDUCE LEAF LITTER FALL INTO POND.



Drawing Status

**FOR INFORMATION**

Subsidiary

-

Woodcote Grove  
Ashley Road  
Epsom  
Surrey  
KT18 5BW  
Tel: +44 (0)1372 726140  
Fax: +44 (0)1372 740055  
www.atkinsglobal.com

Copyright: Atkins Limited (2014)

Client

City of London Corporation

Project Title

HAMPSTEAD HEATH PONDS PROJECT

Drawing Title

KENWOOD LADIE'S BATHING POND  
ENVIRONMENTAL MASTERPLAN

Scale	Designed	Drawn	Checked	Authorised
1:750	NM	IF	NM	LB
Original Size	Date	Date	Date	Date
A3	24/04/14	24/04/14	24/04/14	24/04/14
Drawing Number	Revision			
5117039-ATK-P2-ZZ-DR-L-7005				P1



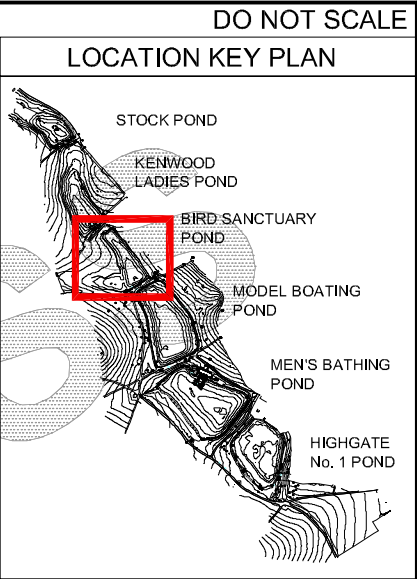
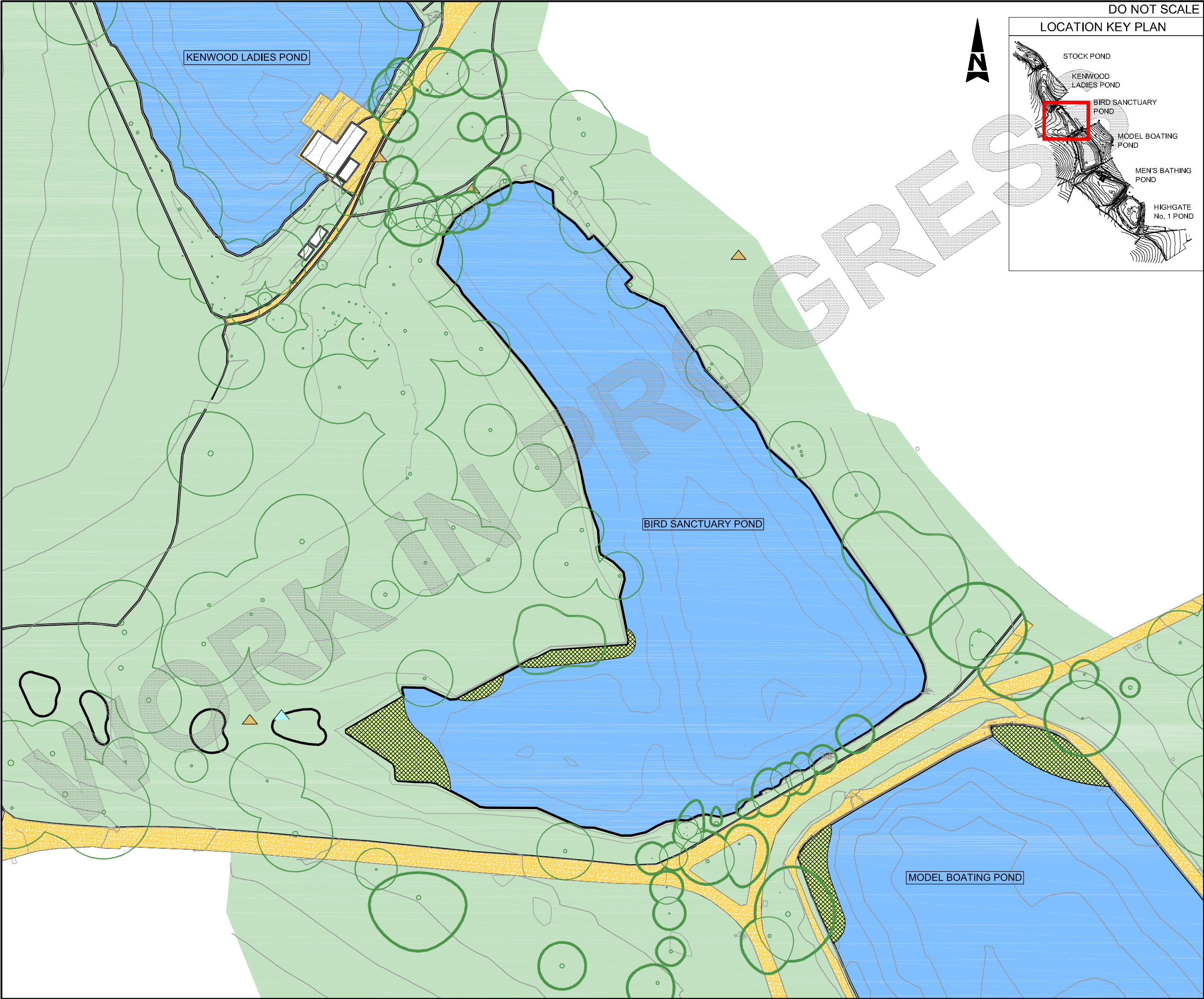

- EXISTING TREES COVERED BY ARBORICULTURAL SURVEY  
Refer to drawing 5117039 COL LAD01-LAD16 for the Arboricultural survey
- EXISTING TREES NOT COVERED BY ARBORICULTURAL SURVEY  
Tree location taken from the Topographical survey
- POSITION OF TREES NOT SURVEYED  
Indicative location provided
- EXISTING LANDSCAPE
- EXISTING HOGWEED PLANTIS  
Approximate location of Hogweed plants to be managed
- EXISTING HIMALAYAN BALSAM  
Approximate location of Himalayan Balsam plants to be managed
- POND
- EXISTING POND VEGETATION
- EXISTING PATH
- CONTOURS
- EXISTING FENCE



Drawing Status: **FOR INFORMATION** Suitability: -

**ATKINS** Woodcote Grove  
Ashley Road  
Epsom  
Surrey  
KT18 5BW  
Tel: +44 (0)1372 726140  
Fax: +44 (0)1372 740055  
www.atkinsglobal.com

Copyright: Atkins Limited (2014)

Client: **City of London Corporation**

Project Title: **HAMPSTEAD HEATH PONDS PROJECT**

Drawing Title: **BIRD SANCTUARY POND  
EXISTING SITE PLAN**

Scale	Designed	Drawn	Checked	Authorised
1:750	NM	IF	NM	LB
Original Size	Date	Date	Date	Date
A3	24/04/14	24/04/14	24/04/14	24/04/14
Drawing Number	Revision			
5117039-ATK-P3-ZZ-DR-L-7006	P1			



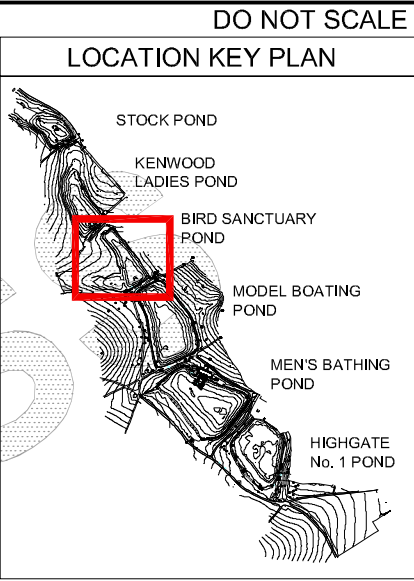
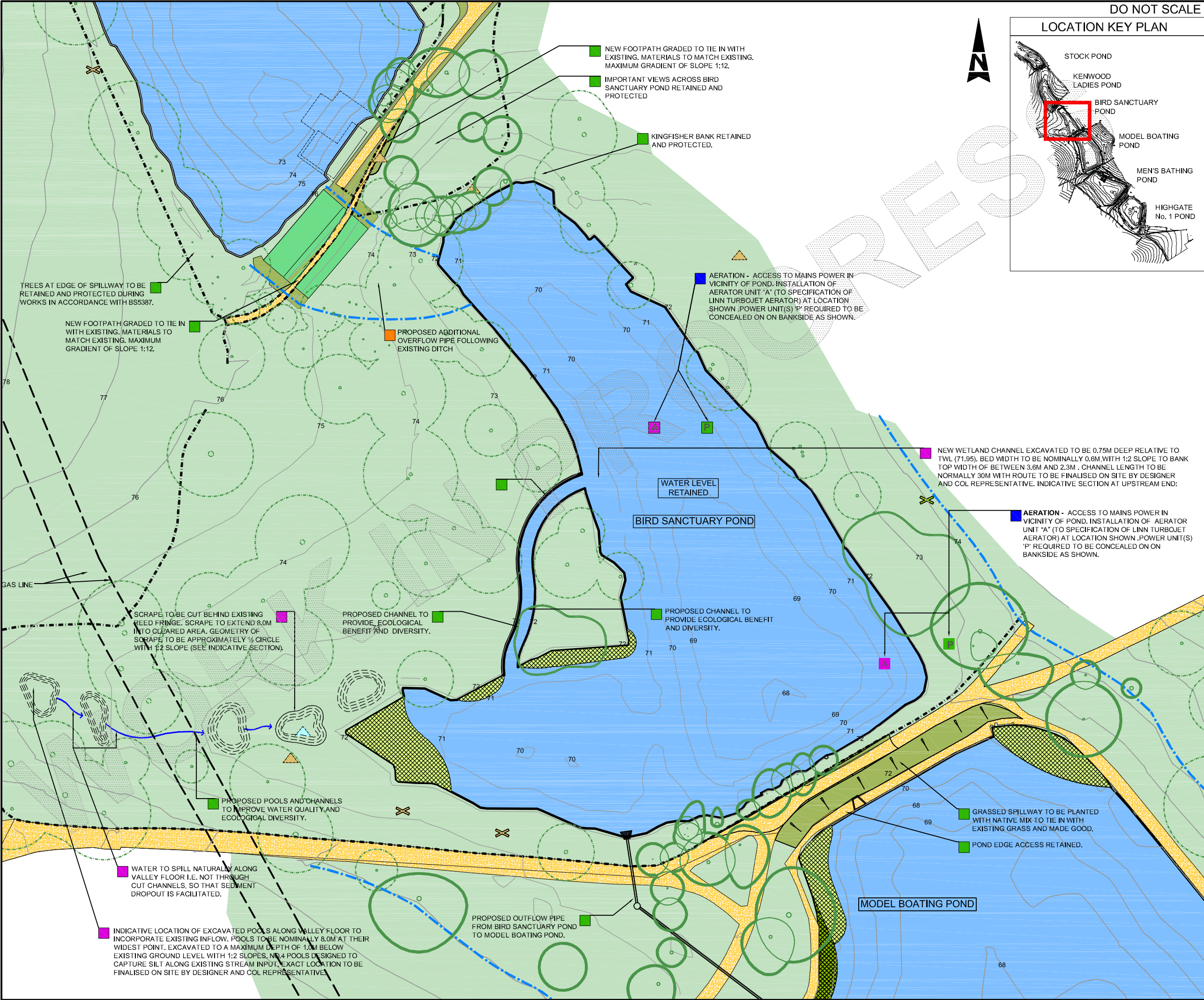

- EXISTING TREES COVERED BY ARBORICULTURAL SURVEY**  
Refer to drawing 5117039 COL LAD01-LAD16 for the Arboricultural survey
- EXISTING TREES NOT COVERED BY ARBORICULTURAL SURVEY**  
Tree location taken for the Topographical survey
- POSITION OF TREES NOT SURVEYED**  
Indicative location provided
- EXISTING LANDSCAPE**
- PROPOSED LOG AND BRASH PILE**  
Approximate location of log/brash pile using filled cut material
- PROPOSED REPTILE AND AMPHIBIAN**  
Approximate location of reptile and amphibian Hibernaculum
- PROPOSED SPILLWAY**  
Refer to the Engineers drawings for details
- PROPOSED SPILLWAY BANKS/ BUNDS**  
Refer to the Engineers drawings for details
- POND**
- EXISTING POND VEGETATION**
- EXISTING PATH**
- REINSTATED PATH**  
Existing path to be extended or reinstated and made good
- CONTOURS**
- EXISTING FENCE LINE**
- AERATOR**
- AERATOR POWER**
- INDICATIVE ROUTE OF FLOOD WATER OVER DAM**
- GIANT HOGWEED PLANTS**  
Indicative location of invasive species to be managed
- HIMALAYAN BALSAM**  
Indicative location of invasive species to be managed

- NOTES RELATING TO ENVIRONMENTAL PROPOSALS**
- LANDSCAPE**
- WATER QUALITY**
- AQUATIC ECOLOGY**
- TERRESTRIAL ECOLOGY**

- NOTES:**
1. LANDSCAPE AND ECOLOGY TO LIAISE REGARDING REINSTATEMENT OF WORKING AREA AND PLANTING.
  2. TREES TO BE PROTECTED DURING CONSTRUCTION IN ACCORDANCE WITH BS5837.
  3. GENERAL TREE MAINTENANCE - SELECTIVE PRUNING OF OVERHANGING TREES AROUND POND PERIMETER TO REDUCE LEAF LITTER FALL INTO POND.

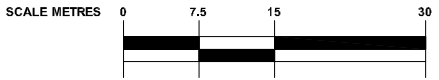

**FOR INFORMATION**

**ATKINS**

Woodcote Grove  
Ashley Road  
Epsom  
Surrey  
KT18 5BW

Tel: +44 (0)1372 726140  
Fax: +44 (0)1372 740055  
www.atkinsglobal.com

Copyright: Atkins Limited (2014)

Client

City of London Corporation

Project Title

HAMPSTEAD HEATH PONDS PROJECT

Drawing Title

BIRD SANCTUARY POND  
ENVIRONMENTAL MASTERPLAN

Scale	Designed	Drawn	Checked	Authorised
1:750	NM	IF	NM	LB
Original Size	Date	Date	Date	Date
A3	24/04/14	24/04/14	24/04/14	24/04/14
Drawing Number	Revision			
5117039-ATK-P3-ZZ-DR-L-7007	P1			



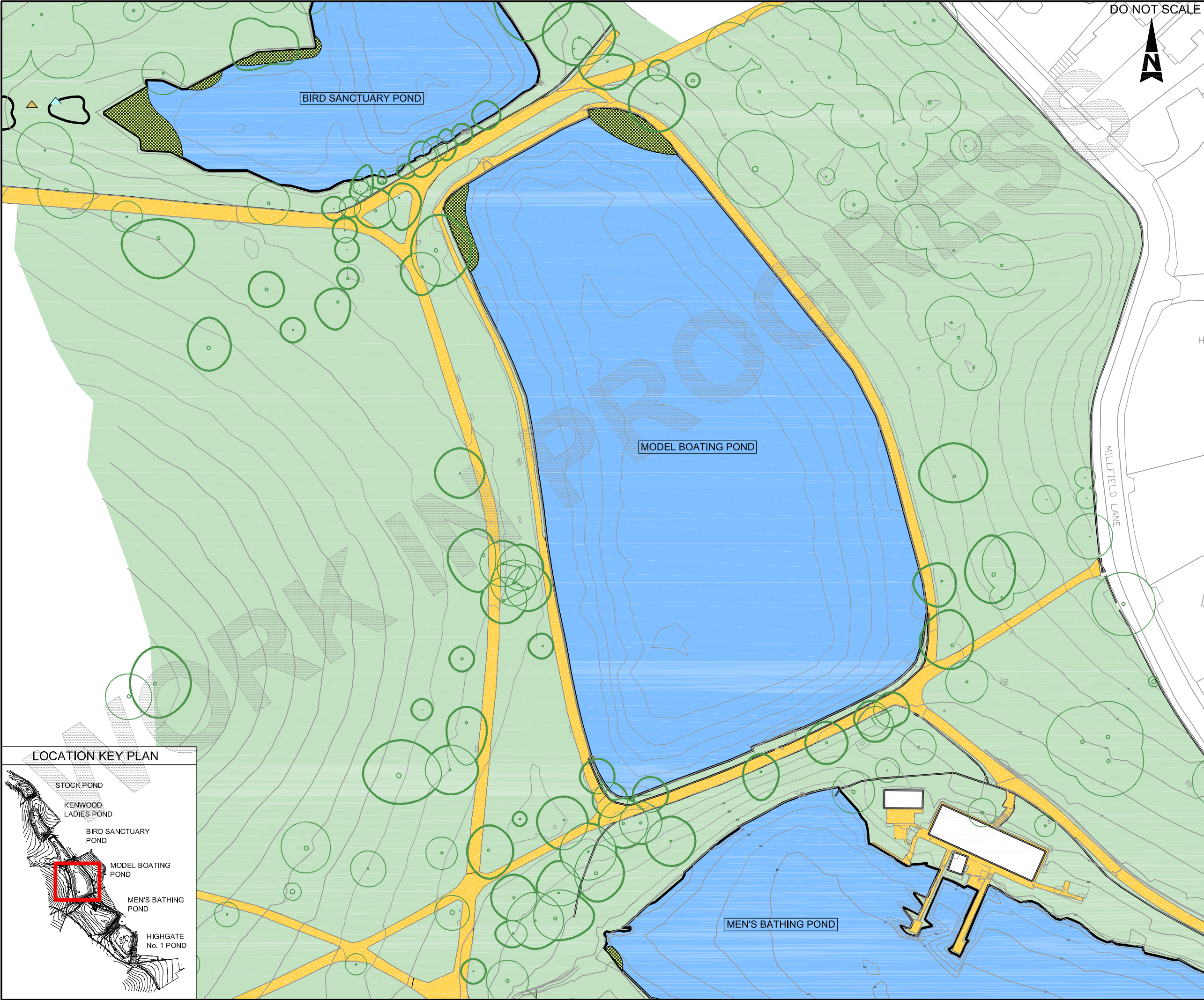

- EXISTING TREES COVERED BY ARBORICULTURAL SURVEY  
Refer to drawing 5117039 COL LAD01-LAB16 for the Arboricultural survey
- EXISTING TREES NOT COVERED BY ARBORICULTURAL SURVEY  
Tree location taken from the Topographical survey
- POSITION OF TREES NOT SURVEYED  
Indicative location provided
- EXISTING LANDSCAPE
- EXISTING HOGWEED PLANTS  
Approximate location of Hogweed plants to be managed
- EXISTING HIMALAYAN BALSAM  
Approximate location of Himalayan Balsam plants to be managed
- POND
- EXISTING POND VEGETATION
- EXISTING PATH
- CONTOURS
- EXISTING FENCE

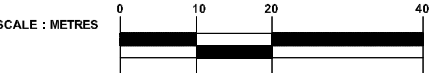

FOR INFORMATION

Woodcote Grove  
Ashley Road  
Epsom  
Surrey  
KT18 5BW

Tel: +44 (0)1372 726140  
Fax: +44 (0)1372 740055  
[www.atkinsglobal.com](http://www.atkinsglobal.com)

Client  
**City of London Corporation**

Project Title  
**HAMPSTEAD HEATH PONDS PROJECT**

Drawing Title  
**MODEL BOATING POND  
EXISTING SITE PLAN**

Scale	Designed	Drawn	Checked	Authorised
1:1000	NM	IF	NM	LB
Original Size	Date	Date	Date	Date
A3	24/04/14	24/04/14	24/04/14	24/04/14
Drawing Number	Revision			
5117039-ATK-P4-ZZ-DR-L-7006	P1			

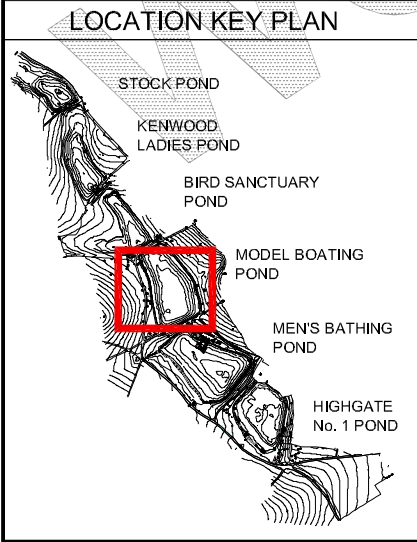



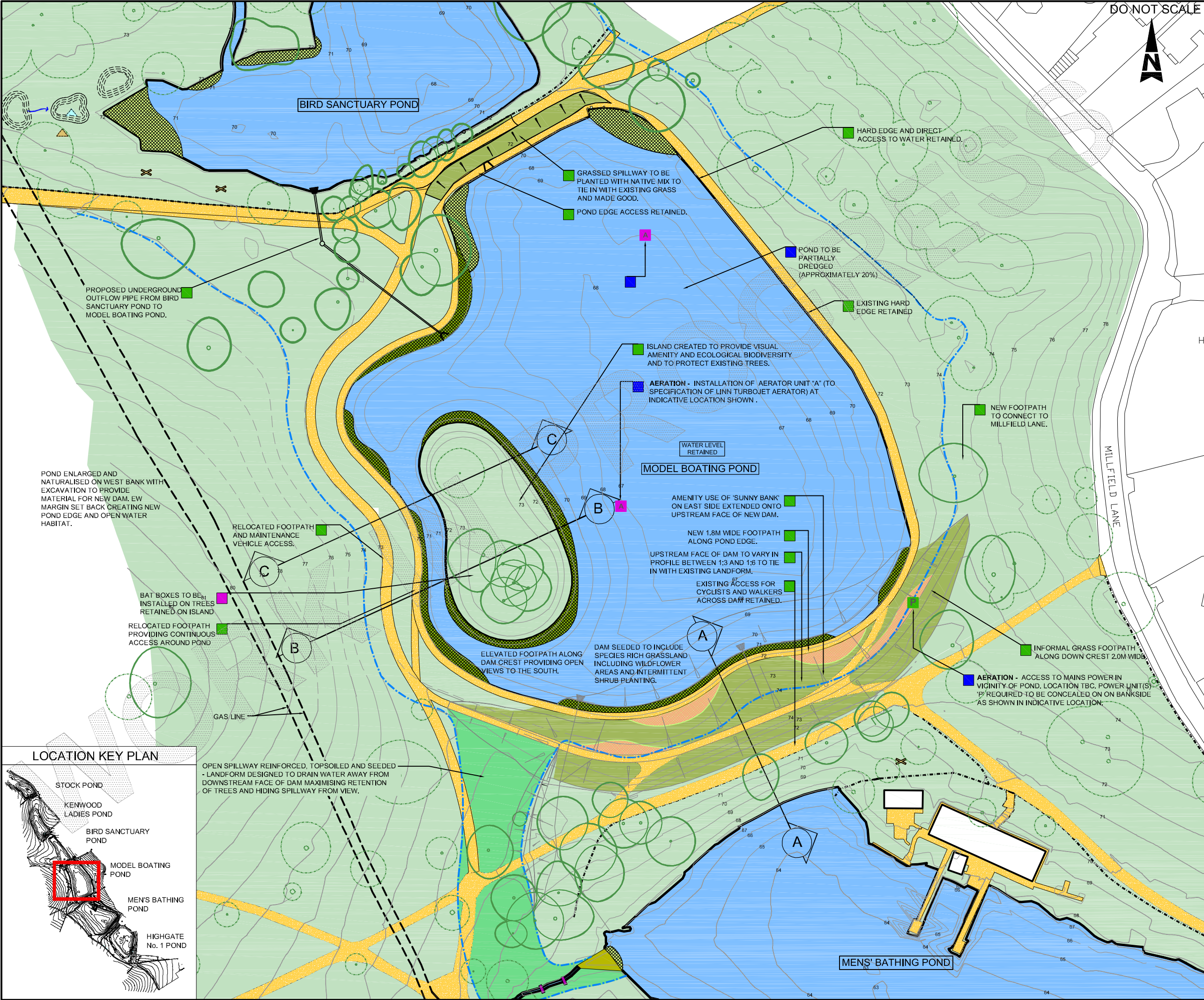

DO NOT SCALE

N

**EXISTING TREES COVERED BY ARBORICULTURAL SURVEY**  
Refer to drawing 5117039 COL LAD01-LAD16 for the Arboricultural survey

**EXISTING TREES NOT COVERED BY ARBORICULTURAL SURVEY**  
Tree location taken from the Topographical survey

**POSITION OF TREES NOT SURVEYED**  
Indicative location provided

**EXISTING LANDSCAPE**

**PROPOSED LOG AND BRASH PILE**  
Approximate location of log/ brash pile using felled/ cut material

**PROPOSED SPILLWAY**  
Refer to the Engineers drawings for details

**PROPOSED SPILLWAY BANKS/ BUNDS**  
Refer to the Engineers drawings for details

**POND**

**EXISTING POND VEGETATION**

**PROPOSED MARGINAL PLANTING PLATFORM**

**EXISTING PATH**

**REINSTATED PATH**  
Existing path to be extended or reinstated and made good

**CONTOURS**

**EXISTING FENCE LINE**

**AERATOR**

**AERATOR POWER**

**INDICATIVE ROUTE OF FLOOD WATER**

**GIANT HOGWEED PLANTS**  
Indicative location of invasive species to be managed

**HIMALAYAN BALSAM**  
Indicative location of invasive species to be managed

- NOTES RELATING TO ENVIRONMENTAL PROPOSALS**
- WATER QUALITY**
  - AQUATIC ECOLOGY**
  - LANDSCAPE**
  - TERRESTRIAL ECOLOGY**

- NOTES:**
- FURTHER LANDSCAPE AND ECOLOGY MEASURES WILL BE IDENTIFIED AS PART OF THE REINSTATEMENT OF THE WORKING AREAS AND SPILLWAY TO MAXIMISE BENEFITS
  - TREES TO BE PROTECTED DURING CONSTRUCTION IN ACCORDANCE WITH BS5837.
  - DREDGING - PRIORITY POND FOR DE-SILT ACTIVITY. DREDGE ENTIRE POND TO HARD BED LEVEL TO REMOVE NUTRIENT-RICH SILT FOR 20% OF POND BASE AREA.
  - GENERAL TREE MAINTENANCE - SELECTIVE PRUNING OF OVERHANGING TREES AROUND POND PERIMETER TO REDUCE LEAF LITTER FALL INTO POND.



Drawing Status: **FOR INFORMATION** Substantive: -

**ATKINS**

Woodcote Grove  
Ashley Road  
Epsom  
Surrey  
KT18 5BW

Tel: +44 (0)1372 726140  
Fax: +44 (0)1372 740055  
www.atkinsglobal.com

Copyright: Atkins Limited (2014)

Client: **City of London Corporation**

Project Title: **HAMPSTEAD HEATH PONDS PROJECT**

Drawing Title: **MODEL BOATING POND ENVIRONMENTAL MASTERPLAN**

Scale	Designed	Drawn	Checked	Authorised
1:1000	NM	IF	NM	LB
Original Size	Date	Date	Date	Date
A3	24/04/14	24/04/14	24/04/14	24/04/14

Drawing Number: **5117039-ATK-P4-ZZ-DR-L-7007** Revision: **P1**



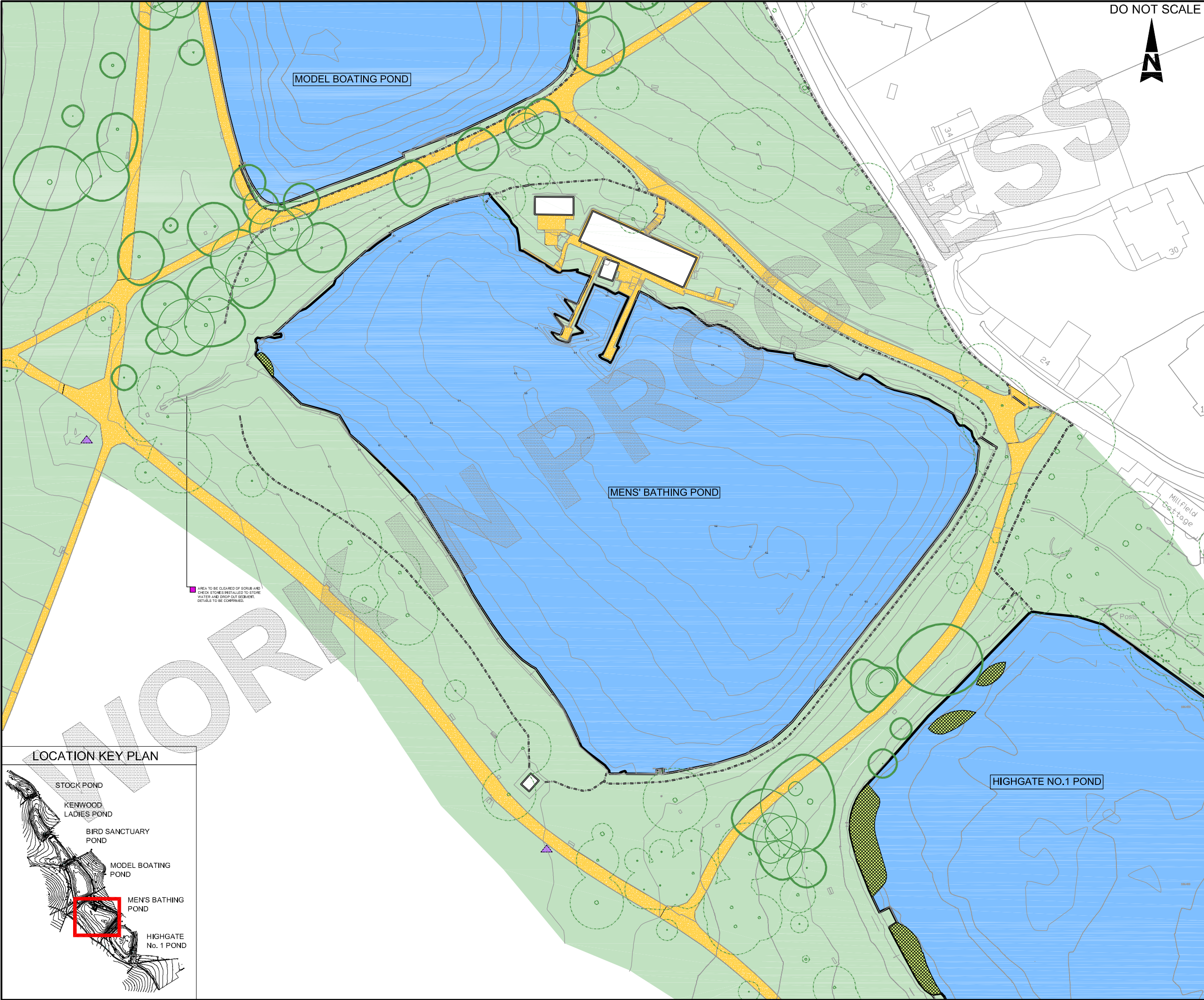

- DO NOT SCALE**
- EXISTING TREES COVERED BY ARBORICULTURAL SURVEY**  
Refer to drawing 5117039 COL LA001-LA016 for the Arboricultural survey
- EXISTING TREES NOT COVERED BY ARBORICULTURAL SURVEY**  
Tree location taken from the Topographical survey
- POSITION OF TREES NOT SURVEYED**  
Indicative location provided
- EXISTING LANDSCAPE**
- EXISTING JAPANESE KNOTWEED**  
Approximate location of Japanese knotweed plants to be managed
- EXISTING HIMALAYAN BALSAM**  
Approximate location of Himalayan Balsam plants to be managed
- POND**
- EXISTING POND VEGETATION**
- EXISTING PATH**
- CONTOURS**
- EXISTING FENCE**

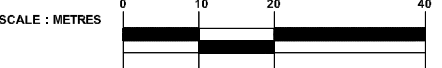

FOR INFORMATION

**ATKINS**

Woodcote Grove  
Ashley Road  
Epsom  
Surrey  
KT18 5BW

Tel: +44 (0)1372 726140  
Fax: +44 (0)1372 740055  
www.atkinsglobal.com

Copyright: Atkins Limited (2014)

Client

City of London Corporation

Project Title

HAMPSTEAD HEATH PONDS PROJECT

Drawing Title

HIGHGATE MENS' BATHING POND  
EXISTING SITE PLAN

Scale	Designed	Drawn	Checked	Authorised
1:1000	NM	IF	NM	LB
Original Size	Date	Date	Date	Date
A3	24/04/14	24/04/14	24/04/14	24/04/14
Drawing Number	Revision			
5117039-ATK-P5-ZZ-DR-L-7006	P1			

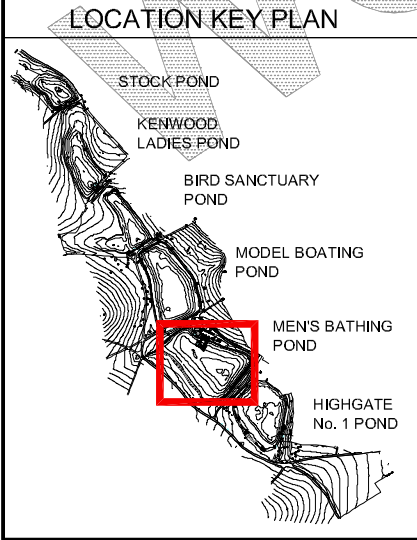



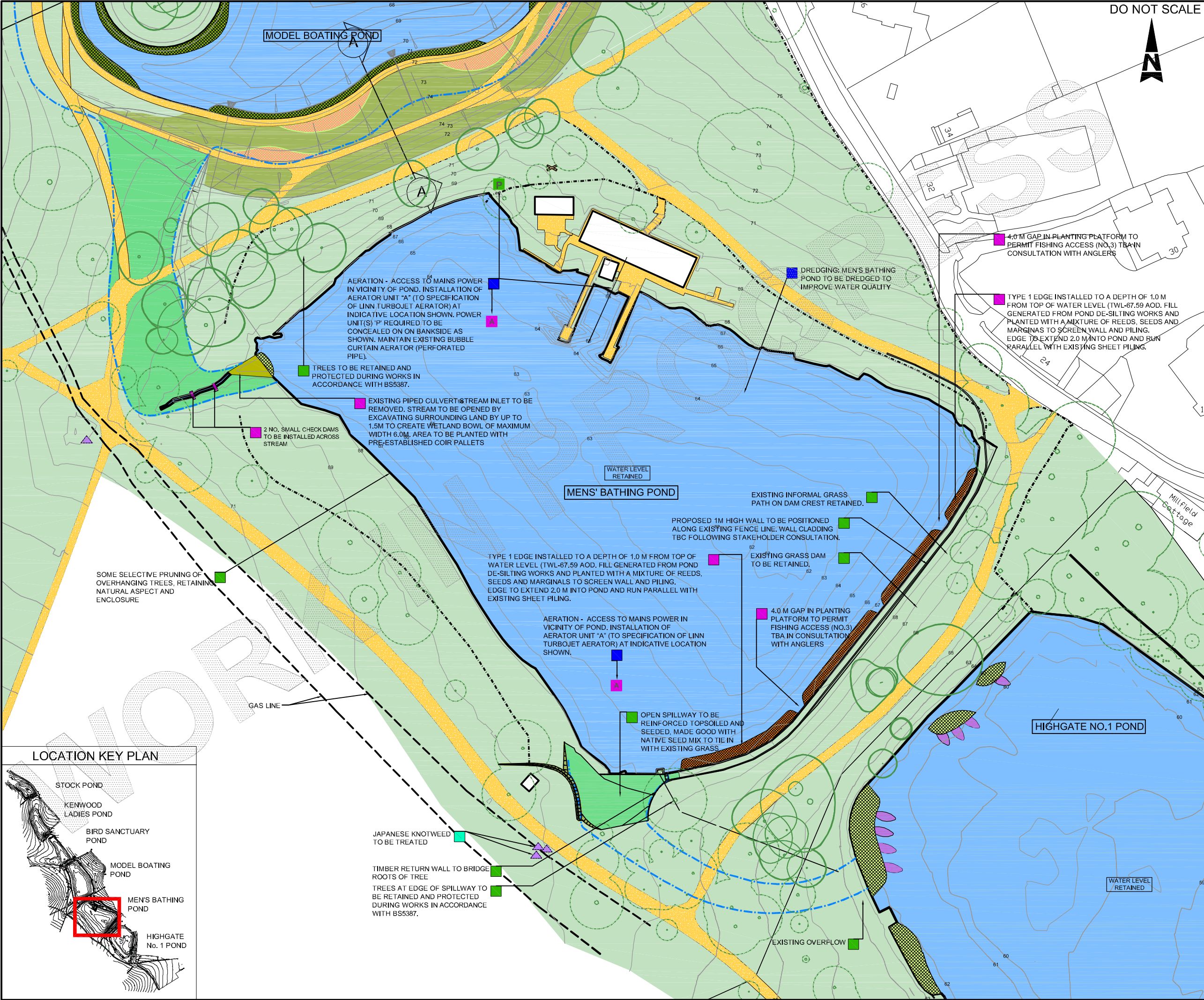

DO NOT SCALE



- EXISTING TREES COVERED BY ARBORICULTURAL SURVEY  
Refer to drawing 5117039 COL LAD01-LAD16 for the Arboricultural survey
- EXISTING TREES NOT COVERED BY ARBORICULTURAL SURVEY  
Tree location taken for the Topographical survey
- POSITION OF TREES NOT SURVEYED  
Indicative location provided
- EXISTING LANDSCAPE
- PROPOSED LOG AND BRASH PILE  
Approximate location of log/brash pile using filled cut material
- PROPOSED SPILLWAY  
Refer to the Engineers drawings for details
- PROPOSED SPILLWAY BANKS/ BUNDS  
Refer to the Engineers drawings for details
- POND
- EXISTING POND VEGETATION
- PROPOSED TYPE 1 POND EDGE  
Refer to details
- EXISTING PATH
- REINSTATED PATH  
Existing path to be extended or reinstated and made good
- CONTOURS
- EXISTING FENCE LINE
- PROPOSED 1M HIGH WALL
- AERATOR
- INDICATIVE ROUTE OF FLOOD WATER
- JAPANESE KNOTWEED  
Indicative location of invasive species to be managed
- HIMALAYAN BALSAM  
Indicative location of invasive species to be managed
- AERATOR POWER

- NOTES RELATING TO ENVIRONMENTAL PROPOSALS
- WATER QUALITY
  - AQUATIC ECOLOGY
  - LANDSCAPE
  - TERRESTRIAL ECOLOGY

NOTES:

1. THERE MAYBE FURTHER JAPANESE KNOTWEED PLANT IN THIS AREA. THE JAPANESE KNOTWEED WAS IDENTIFIED DURING A HABITAT SURVEY IN SUMMER 2013
2. TREES TO BE PROTECTED DURING CONSTRUCTION IN ACCORDANCE WITH BS5387.
3. BAT BOXES TO BE INSTALLED ON TREES ADJACENT TO TREE LOSS
4. DREDGING - PRIORITY POND FOR DE-SILT ACTIVITY. DREDGE ENTIRE POND TO HARD BED LEVEL TO REMOVE NUTRIENT-RICH SILT.
5. GENERAL TREE MAINTENANCE - SELECTIVE PRUNING OF OVERHANGING TREES AROUND POND PERIMETER TO REDUCE LEAF LITTER FALL INTO POND.

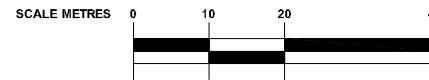

FOR INFORMATION

**ATKINS**  
Woodcote Grove  
Ashley Road  
Epsom  
Surrey  
KT18 5BW  
Tel: +44 (0)1372 726140  
Fax: +44 (0)1372 740055  
www.atkinsglobal.com

Copyright: Atkins Limited (2014)

Client: City of London Corporation

Project Title: HAMPSTEAD HEATH PONDS PROJECT

Drawing Title: HIGHGATE MENS' BATHING POND ENVIRONMENTAL MASTERPLAN

Scale	Designed	Drawn	Checked	Authorised
1:1000	NM	IF	NM	LB
Original Size	Date	Date	Date	Date
A3	24/04/14	24/04/14	24/04/14	24/04/14
Drawing Number	Revision			
5117039-ATK-P5-ZZ-DR-L-7007	P1			



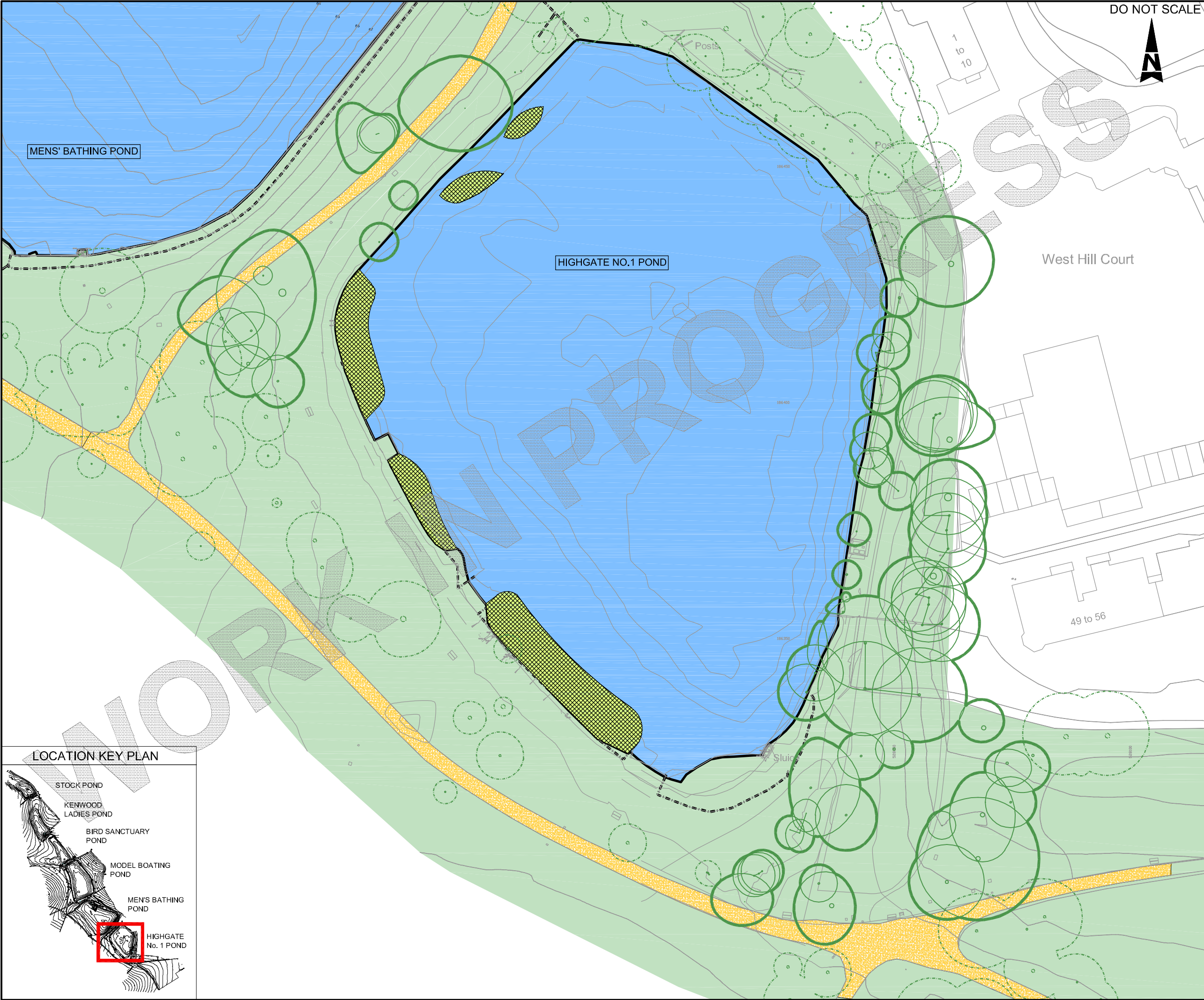

DO NOT SCALE

- EXISTING TREES COVERED BY ARBORICULTURAL SURVEY  
Refer to drawing 5117039 COL LAD01-LAB16 for the Arboricultural survey
- EXISTING TREES NOT COVERED BY ARBORICULTURAL SURVEY  
Tree location taken from the Topographical survey
- POSITION OF TREES NOT SURVEYED  
Indicative location provided
- EXISTING LANDSCAPE
- EXISTING POND VEGETATION
- EXISTING PATH
- CONTOURS
- EXISTING FENCE

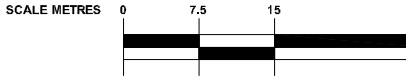

FOR INFORMATION

**ATKINS**  
Woodcote Grove  
Ashley Road  
Epsom  
Surrey  
KT18 5BW  
Tel: +44 (0)1372 726140  
Fax: +44 (0)1372 740055  
www.atkinsglobal.com

Client  
**City of London Corporation**

Project Title  
**HAMPSTEAD HEATH PONDS PROJECT**

Drawing Title  
**HIGHGATE NO.1 POND  
EXISTING SITE PLAN**

Scale	Designed	Drawn	Checked	Authorised
1:750	NM	IF	NM	LB
Original Size	Date	Date	Date	Date
A3	24/04/14	24/04/14	24/04/14	24/04/14
Drawing Number	Revision			
5117039-ATK-P6-ZZ-DR-L-7004	P1			

LOCATION KEY PLAN

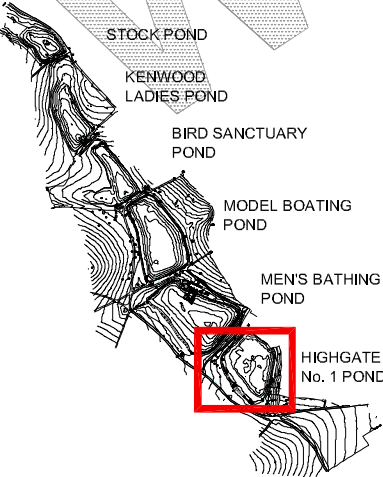



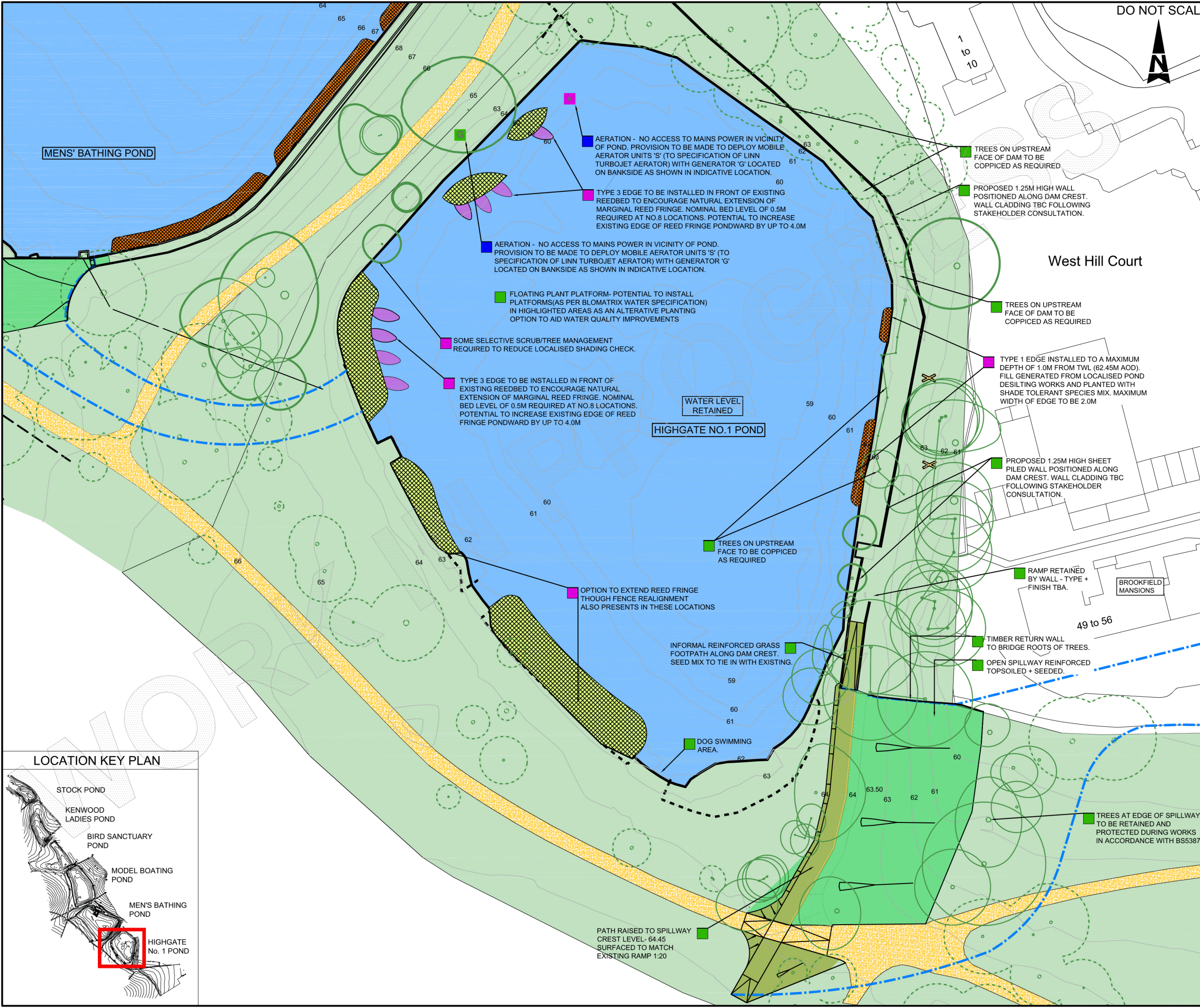

DO NOT SCALE



1  
to  
10

MENS' BATHING POND

AERATION - NO ACCESS TO MAINS POWER IN VICINITY OF POND. PROVISION TO BE MADE TO DEPLOY MOBILE AERATOR UNITS 'S' (TO SPECIFICATION OF LINN TURBOJET AERATOR) WITH GENERATOR 'G' LOCATED ON BANKSIDE AS SHOWN IN INDICATIVE LOCATION.

TYPE 3 EDGE TO BE INSTALLED IN FRONT OF EXISTING REEDBED TO ENCOURAGE NATURAL EXTENSION OF MARGINAL REED FRINGE. NOMINAL BED LEVEL OF 0.5M REQUIRED AT NO.8 LOCATIONS. POTENTIAL TO INCREASE EXISTING EDGE OF REED FRINGE PONDWARD BY UP TO 4.0M

AERATION - NO ACCESS TO MAINS POWER IN VICINITY OF POND. PROVISION TO BE MADE TO DEPLOY MOBILE AERATOR UNITS 'S' (TO SPECIFICATION OF LINN TURBOJET AERATOR) WITH GENERATOR 'G' LOCATED ON BANKSIDE AS SHOWN IN INDICATIVE LOCATION.

FLOATING PLANT PLATFORM- POTENTIAL TO INSTALL PLATFORMS(AS PER BLOMATRIX WATER SPECIFICATION) IN HIGHLIGHTED AREAS AS AN ALTERNATIVE PLANTING OPTION TO AID WATER QUALITY IMPROVEMENTS

SOME SELECTIVE SCRUB/TREE MANAGEMENT REQUIRED TO REDUCE LOCALISED SHADING CHECK.

TYPE 3 EDGE TO BE INSTALLED IN FRONT OF EXISTING REEDBED TO ENCOURAGE NATURAL EXTENSION OF MARGINAL REED FRINGE. NOMINAL BED LEVEL OF 0.5M REQUIRED AT NO.8 LOCATIONS. POTENTIAL TO INCREASE EXISTING EDGE OF REED FRINGE PONDWARD BY UP TO 4.0M

WATER LEVEL  
RETAINED

HIGHGATE NO.1 POND

TREES ON UPSTREAM  
FACE OF DAM TO BE  
COPPCED AS REQUIRED

PROPOSED 1.25M HIGH WALL  
POSITIONED ALONG DAM CREST.  
WALL CLADDING TBC FOLLOWING  
STAKEHOLDER CONSULTATION.

West Hill Court

TREES ON UPSTREAM  
FACE OF DAM TO BE  
COPPCED AS REQUIRED

TYPE 1 EDGE INSTALLED TO A MAXIMUM  
DEPTH OF 1.0M FROM TWL (62.45M AOD).  
FILL GENERATED FROM LOCALISED POND  
DESILTING WORKS AND PLANTED WITH  
SHADE TOLERANT SPECIES MIX. MAXIMUM  
WIDTH OF EDGE TO BE 2.0M

PROPOSED 1.25M HIGH SHEET  
PILED WALL POSITIONED ALONG  
DAM CREST. WALL CLADDING TBC  
FOLLOWING STAKEHOLDER  
CONSULTATION.

RAMP RETAINED  
BY WALL - TYPE +  
FINISH TBA.

BROOKFIELD  
MANSIONS

49 to 56

TIMBER RETURN WALL  
TO BRIDGE ROOTS OF TREES.

OPEN SPILLWAY REINFORCED  
TOPSOILED + SEED.

INFORMAL REINFORCED GRASS  
FOOTPATH ALONG DAM CREST.  
SEED MIX TO TIE IN WITH EXISTING.

DOG SWIMMING  
AREA.

TREES AT EDGE OF SPILLWAY  
TO BE RETAINED AND  
PROTECTED DURING WORKS  
IN ACCORDANCE WITH BS5387.

PATH RAISED TO SPILLWAY  
CREST LEVEL- 64.45  
SURFACED TO MATCH  
EXISTING RAMP 1:20

**EXISTING TREES COVERED BY ARBORICULTURAL SURVEY**  
Refer to drawing 5117039 COL LA001-LA016 for the Arboricultural survey

**EXISTING TREES NOT COVERED BY ARBORICULTURAL SURVEY**  
Tree location taken for the Topographical survey

**POSITION OF TREES NOT SURVEYED**  
Indicative location provided.

**EXISTING LANDSCAPE**

**PROPOSED LOG AND BRASH PILE**  
Approximate location of log/ brash pile using felled/ cut material

**PROPOSED SPILLWAY**  
Refer to the Engineers drawings for details

**PROPOSED SPILLWAY BANKS/ BUNDS**  
Refer to the Engineers drawings for details

**POND**

**EXISTING POND VEGETATION**

**PROPOSED TYPE 1 POND EDGE**  
Refer to detail

**PROPOSED TYPE 3 POND EDGE**  
Refer to detail

**EXISTING PATH**

**REINSTATED PATH**  
Existing path to be extended or reinstated and made good

**CONTOURS**

**EXISTING FENCE LINE**

**AERATOR**

**INDICATIVE ROUTE OF FLOOD WATER**

**AERATOR POWER**

**NOTES RELATING TO ENVIRONMENTAL PROPOSALS**

**WATER QUALITY**

**AQUATIC ECOLOGY**

**LANDSCAPE**

**TERRESTRIAL ECOLOGY**

- NOTES:**
- BAT BOXES TO BE INSTALLED ON TREES - LOCATION AND EXTENT TBC DEPENDING ON TREE LOSS IN THIS AREA AND WHETHER ANY TREES WITH POTENTIAL FOR ROOSTING BATS WILL BE LOST
  - FURTHER LANDSCAPE AND ECOLOGY MEASURES WILL BE IDENTIFIED AS PART OF THE REINSTATEMENT OF WORKING AREAS TO MAXIMISE BENEFITS
  - TREES TO BE PROTECTED DURING CONSTRUCTION IN ACCORDANCE WITH BS5837.
  - GENERAL TREE MAINTENANCE - SELECTIVE PRUNING OF OVERHANGING TREES AROUND POND PERIMETER TO REDUCE LEAF LITTER FALL INTO POND.

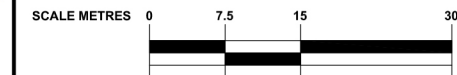

Drawing Status **FOR INFORMATION** Suitability -

**ATKINS**

Woodcote Grove  
Ashley Road  
Epsom  
Surrey  
KT18 5BW

Tel: +44 (0)1372 726140  
Fax: +44 (0)1372 740055  
www.atkinsglobal.com

Client

**City of London Corporation**

Project Title

**HAMPSTEAD HEATH PONDS PROJECT**

Drawing Title

**HIGHGATE NO.1 POND  
ENVIRONMENTAL MASTERPLAN**

Scale	1:750	Designed	NM	Drawn	IF	Checked	NM	Authorised	LB
Original Size	A3	Date	24/04/14	Date	24/04/14	Date	24/04/14	Date	24/04/14
Drawing Number								Revision	
5117039-ATK-P6-ZZ-DR-L-7005								P1	

**LOCATION KEY PLAN**

